



# TYGER®

## FENDER FLARE

Scan to Download the Latest Digital Version



### ATTENTION!

PLEASE READ THE INSTRUCTIONS CAREFULLY BEFORE STARTING INSTALLATION. FOLLOW EACH STEP AS DESCRIBED ON THIS OFFICIAL GUIDE. FAILURE TO DO SO MAY CAUSE DAMAGE TO YOUR VEHICLE AND VOID THE WARRANTY.



### WARNING!

DIRT OR DEBRIS MAY BECOME LODGED BETWEEN FLARES AND BODY PANEL CAUSING SCRATCHING AND PAINT-WEAR AS A RESULT OF VEHICLE VIBRATION. TYGER™ IS NOT RESPONSIBLE FOR SUCH DAMAGE, AND INSTALLATION IS DONE WITH BUYER'S UNDERSTANDING THAT THIS DAMAGE MAY OCCUR.

#### PRIOR TO INSTALLATION:



CHECK EVERYTHING BEFORE INSTALLATION



USE NON-ABRASIVE SURFACE TO INSTALL

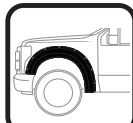

VERIFY FITMENT OF FLARES TO VEHICLE



REMOVE DECALS & MUD FLAPS FIRST



ABRASIVE DETERGENT IS PROHIBITED

#### SAFETY INFORMATION:



NO AUTOMATIC BRUSH-STYLE WASH



CHECK TIGHTNESS



CHECK CAREFULLY BEFORE DRIVE

**ABOUT PAINTING:** Painted flares cannot be returned. Test fit before painting. We are not responsible for any costs that may incur if flares were painted without test fitting.

- Clean surface to be painted with a good grade degreaser. Do not use lacquer thinner or any solvent based product.
- Wipe flare surface completely dry with a tack rag prior to paint.
- Application of plastic adhesion promoter for PP plastic as per your paint system manufacturer's recommendations is required.
- Use a high quality enamel or polyurethane automotive paint to paint the flares.
- Not recommend to paint the edge trim, but if desired use a flex additive.

### Parts List:

TG-FF8T4518



Driver/Left Side Front Flare



Passenger/Right Side Front Flare



Driver/Left Side Rear Flare



Passenger/Right Side Rear Flare

360"



[A] Edge Trim

x2



[B] Long Screw

x36



[C] 5/16" SS Torx Screw

x35



[D] SS Washer

x36



[E] Nylock Nut

x2



[F] 5mm Spacer

x1



[G] T45 Torx Bit

x6



[H] Attachment Clip

x1



[I] Edge Trim Tool

#### Tools For Easier Installation

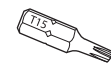

T15 Torx Bit



Measuring Tape

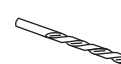

3/32" Drill Bit

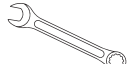

1/2" Wrench

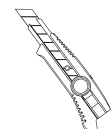

Utility Knife

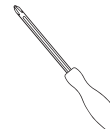

#2 Phillips Driver



10mm Socket Wrench



Pry Tool

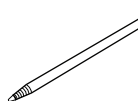

Grease Pencil



Work Gloves

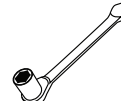

Socket Wrench

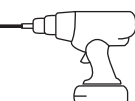

Electric Drill

**DAMAGED or MISSING parts?**

[www.tygerauto.com/contact](http://www.tygerauto.com/contact)



## Fitment or Gap Issue?

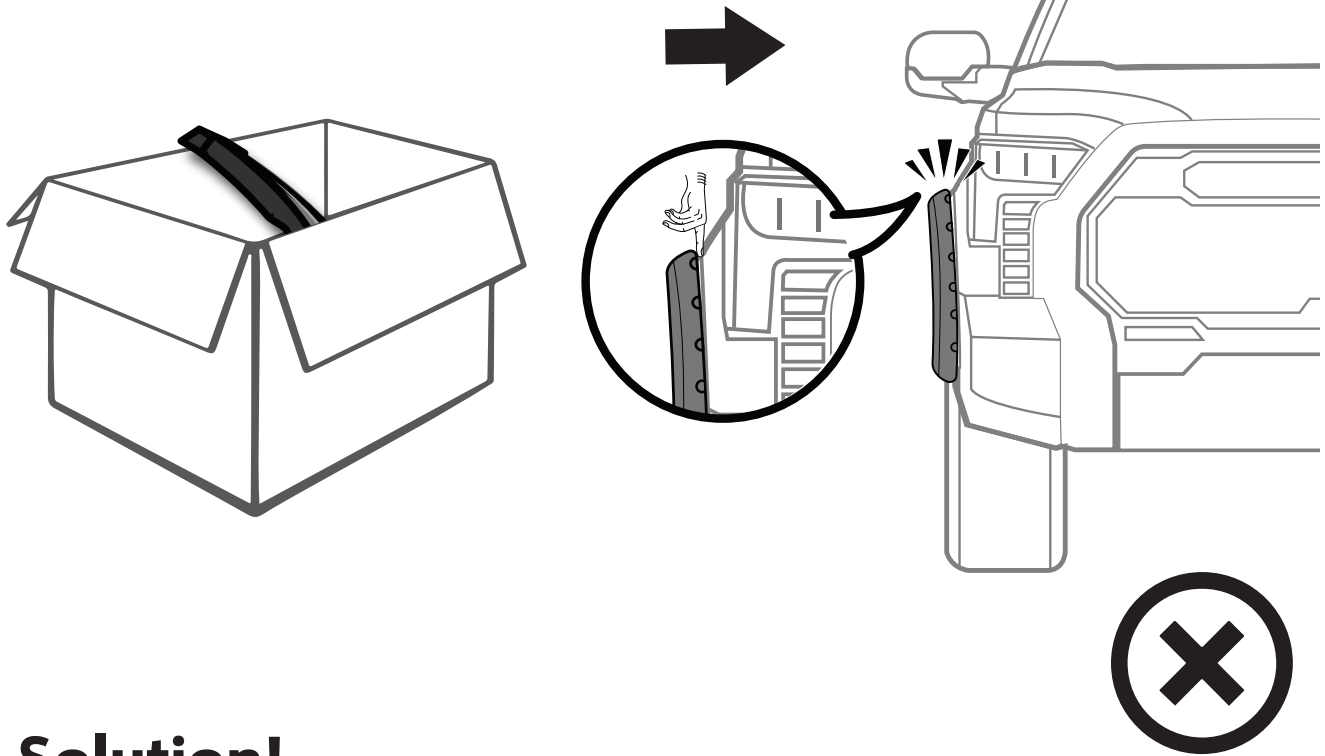

## Solution!

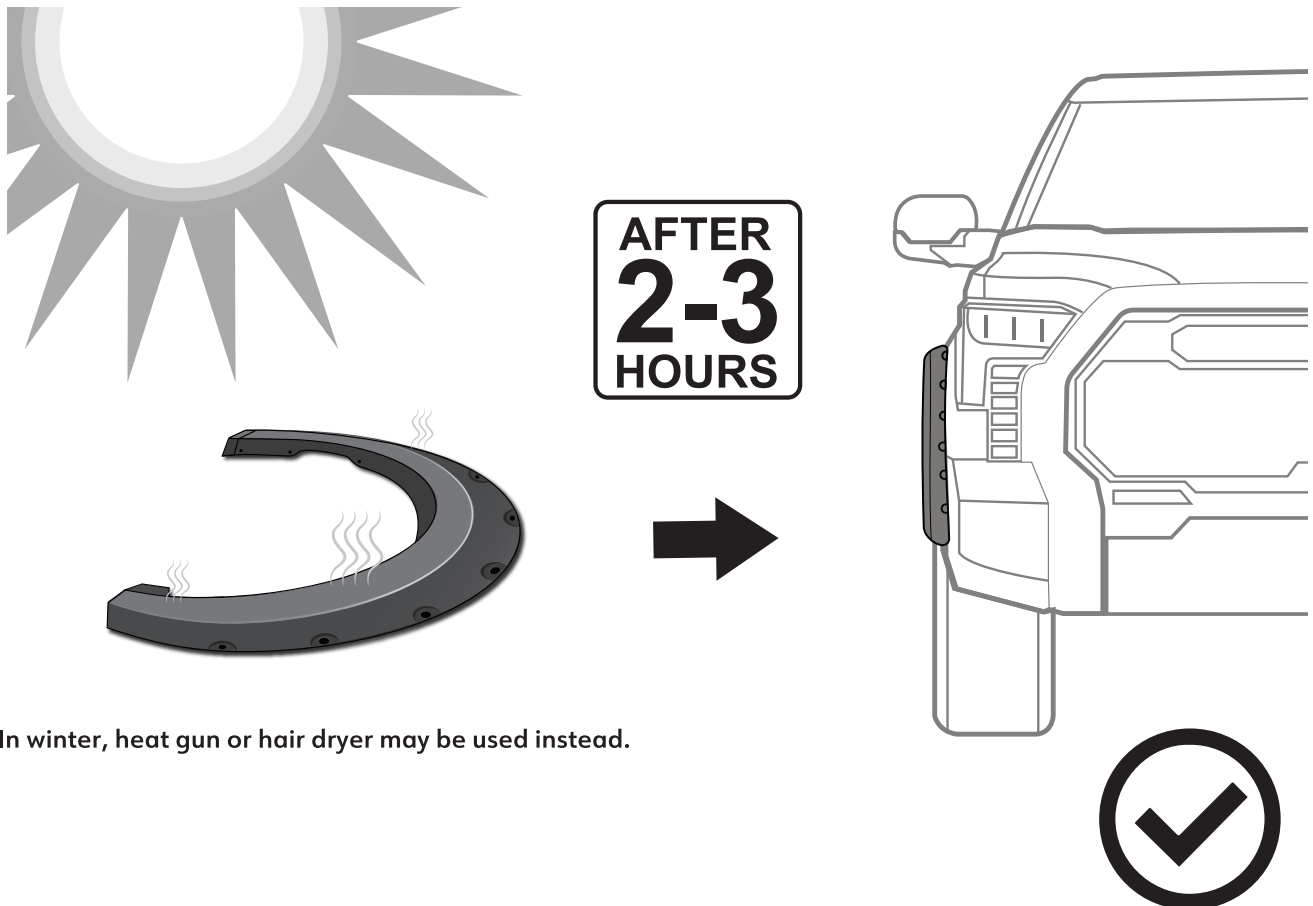

\*In winter, heat gun or hair dryer may be used instead.

# Edge Trim Installation

Peel 2 to 3" of red vinyl backing off from one end of the **Edge Trim [A]**.

- Apply **Edge Trim [A]** over top edge of flare with adhesive side attached to the inside edge of flare.
- Press **Edge Trim [A]** into place and apply thumb pressure to ensure good adhesion, continue to peel off red backing as you work your way along flare edge in one-foot increments.
- **FRONT FLARES ONLY:** The edge trim must be cut to prevent bunching and stretching at the forward end of the part where the flare goes along the headlight.

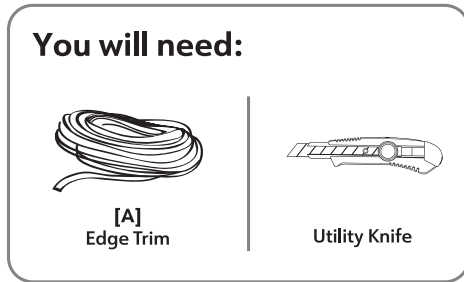

## ⚠ Note!

DO NOT stretch Edge Trim during application.

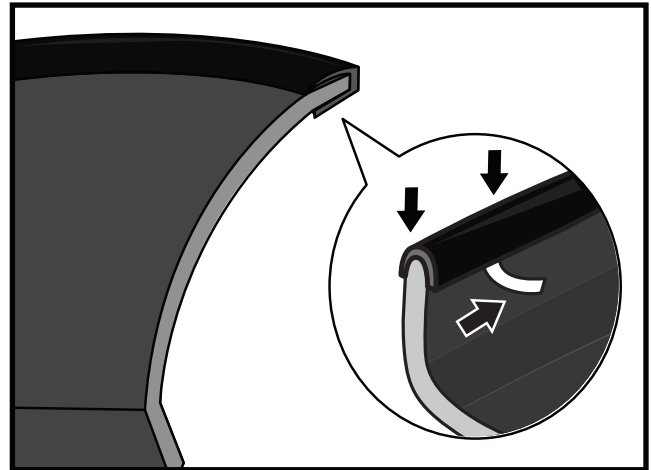

# Decorative Rivet Installation

- Thread a **Torx Bolt [C]** with a **Washer [D]** through each of the pocket holes around the flare and use a **Nylock Nut [E]** to secure it from the other side. Use a socket wrench and the supplied **Torx Bit [G]** on an electric drill to tighten bolts. DO NOT over-tighten as this may damage the flare.

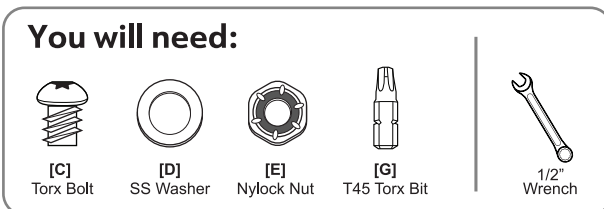

## ⚠ Note!

- DO NOT drill holes on the vehicle body as rivets are decorative and fasten only to the flare. Do not attempt to use the bolts to fasten flare to vehicle body.
- All exposed fasteners and bare metal should be treated with rust resistant paint before installing flares. Spray inner fender wells with undercoating after flare installation.
- Vehicles with large tires may require lowering bump stops and/or installing steering stops to prevent tire from contacting flares.
- Modification may be necessary to maintain a minimum 4" clearance between flares and exhaust pipes. (Exhaust gas should not vent directly onto flares)

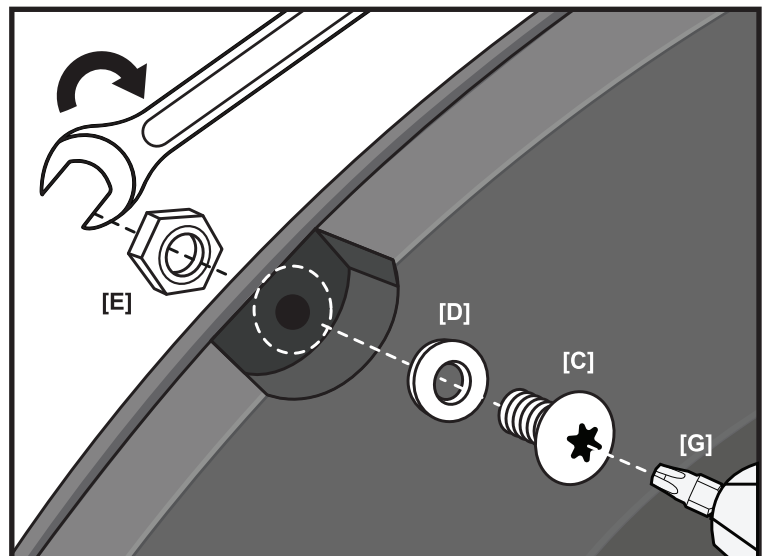

# Front Flares Installation

(Start from the Driver Side) \*Picture may differ from actual part



## NOTE!

Only use appropriate cleaning supplies for your vehicle. If needed, clean and dry off before you begin installing.



## ATTENTION!

Work gloves are recommended for protection against possible sharp objects during installation.

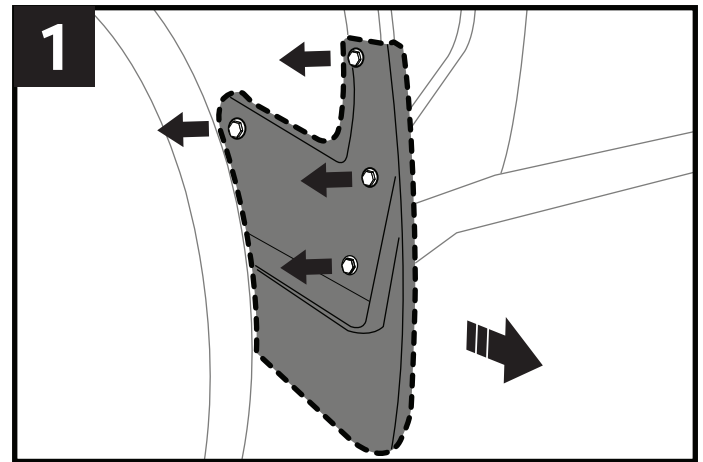
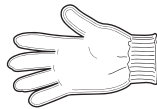

### For models with factory mud guards

1. For models with factory mud guard - First, uninstall the 4 factory screws shown. Remove the mud guard then reinstall the 4 factory screws to the vehicle. Mud guards cannot be installed with the Fender Flares.



2. The Tyger Fender Flares are installed directly over the factory overfenders, so thoroughly clean the factory fender area surfaces and dry off completely. Turn the wheel outward to open up wheel well space to improve access for installation.

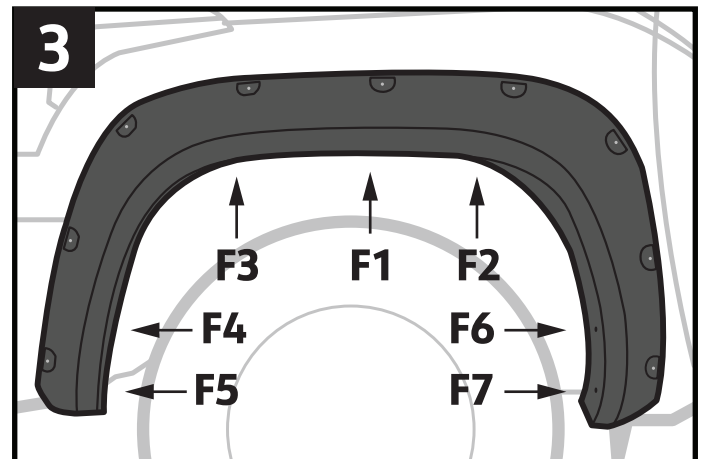

3. Take the Driver Side Front Fender Flare then place and align it over the factory fender. Identify and note the 7 holes used for mounting then set aside the Fender Flare.

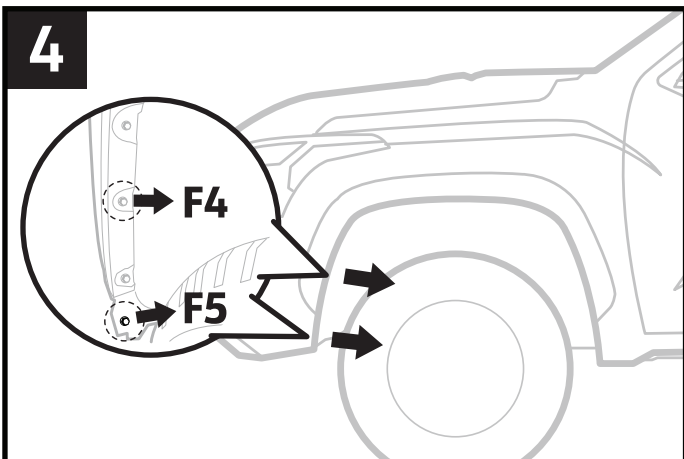

4. With a 10mm socket/wrench, remove F4 and F5 screws from the inner splash guard from Fig 4. Keep the screws for reuse.

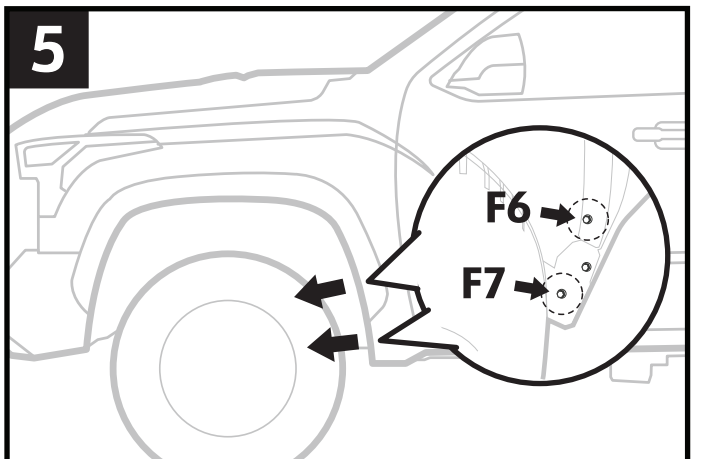

5. Remove F6 and F7 screws from the inner splash guard from Fig 4. Keep the screws for .

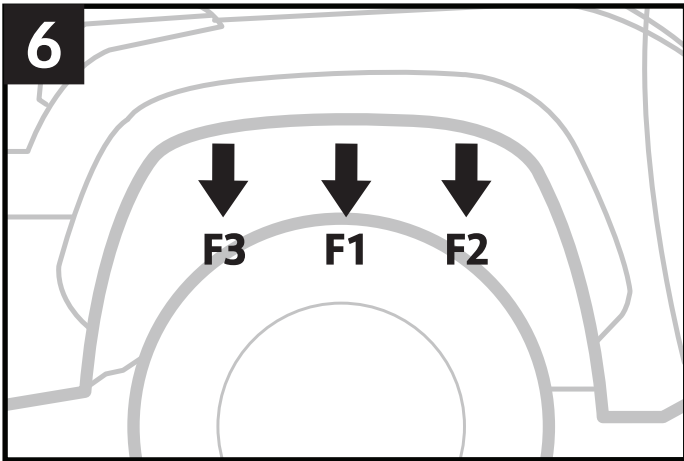

6. Remove **F1**, **F2** and **F3** screws from the upper wheel well area from Fig 3. Keep the screws for reuse.

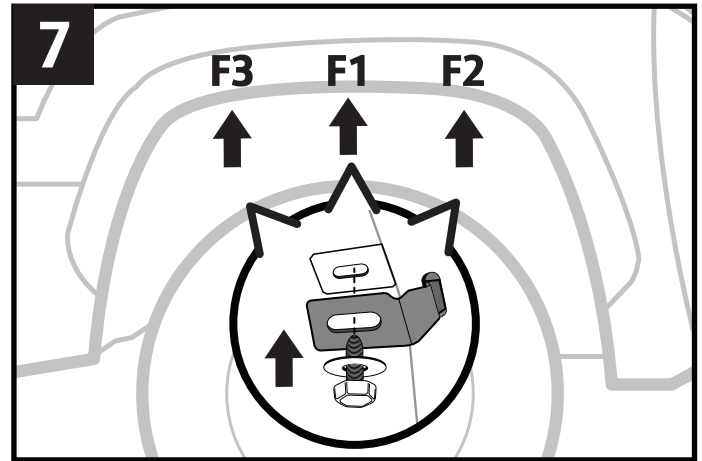

7. For each hole locations (**F1**, **F2** & **F3**) on the upper area, slide a supplied Attachment Clip into the small slot in the Fender Flare. Align the clip hole with each factory holes adjacent to the Fender Flare then loosely reinstall a factory screw removed in **STEP 6** into the clip and factory holes.

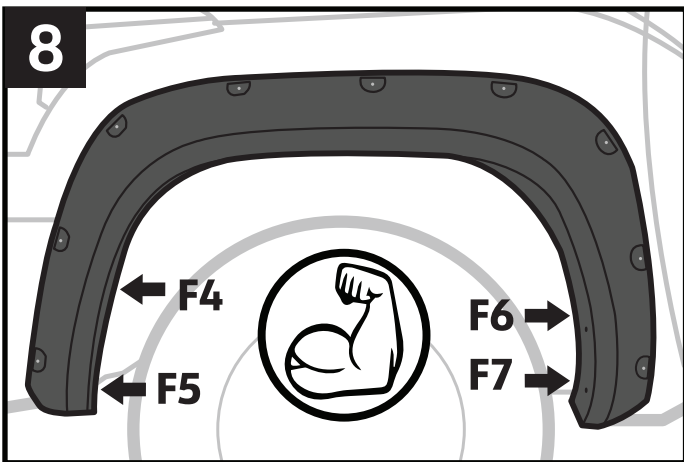

8. Then loosely install 4 factory screws removed in **STEPS 4-5** into hole locations **F4-F7** in the Fender Flare. Adjust the position of the flare and then press firmly into the flare before tightening each screw in the sequence from **F1** to **F7** for the best fit.



9. Make any additional adjustments to improve positioning of the flare. Follow the screw sequence number while tightening. Once finished, repeat **STEPS 1** to **9** for the passenger side Fender Flare.

# Rear Flares Installation

(Start from the Driver Side) \*Picture may differ from actual part

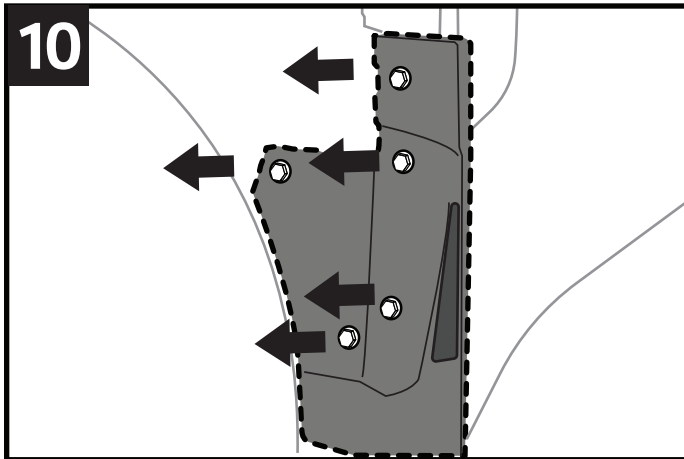

### For models with factory mud guards

1. For models with factory mud guard - Uninstall the 5 factory screws on the mud guard (shown) and the Remove the mud guard then reinstall the factory screws to the vehicle. Mud guards cannot be installed with the Fender Flares.

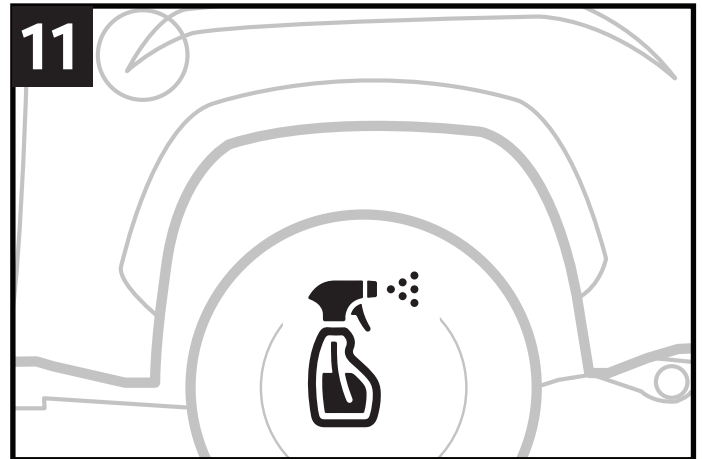

11. Thoroughly clean the factory fender area surfaces and dry off completely.

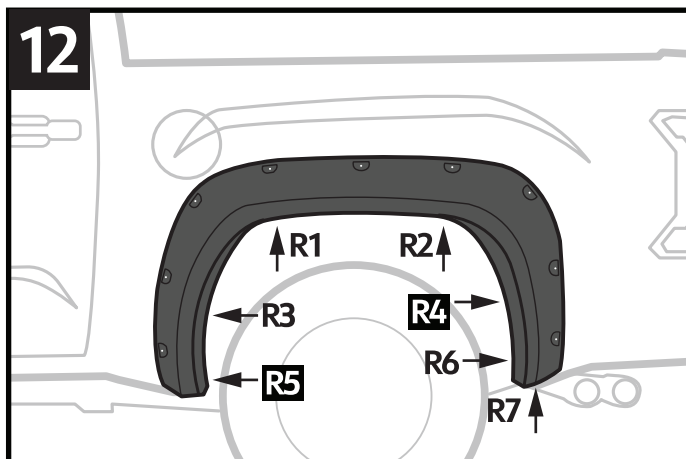

12. Take the Driver Side Rear Fender Flare then place and align it over the factory fender. Identify and note the 7 holes used for mounting then set aside the Fender Flare.

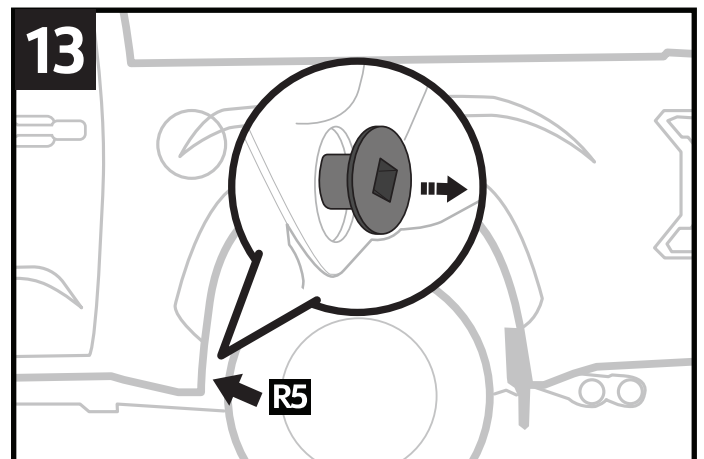

13. Find the Factory Retainer Plug (R5 position) at the bottom of the frontward side of the rear wheel. Squeeze the plug from the back side to remove it. Factory Plug will be reused.

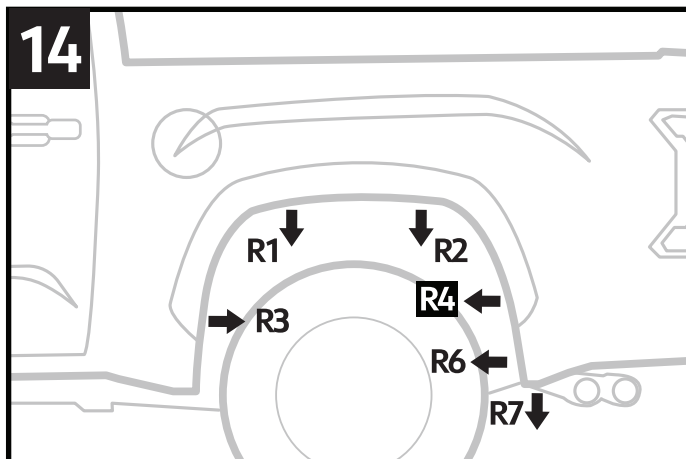

14. With a 10mm socket/wrench, remove the factory screws from each of the 6 screw locations shown. Keep 5 screws to be reused (except for R4).

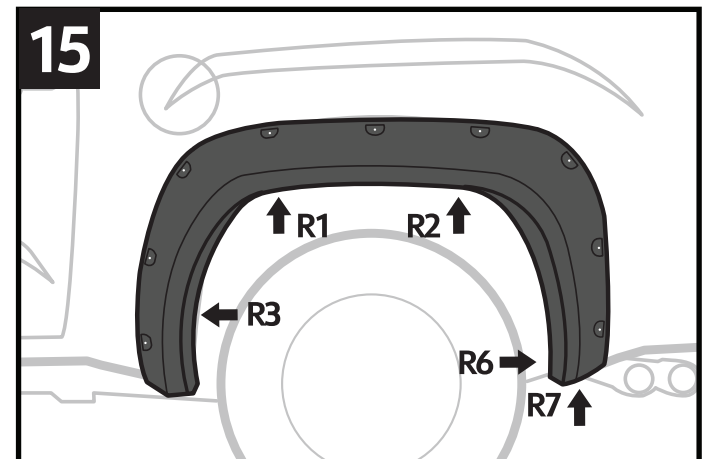

15. First loosely re-install the 5 screws removed in STEP 14 into the R1, R2, R3, R6 & R7 hole locations in the Fender Flare. Continue to STEP 16 for R4 and R5 installation.

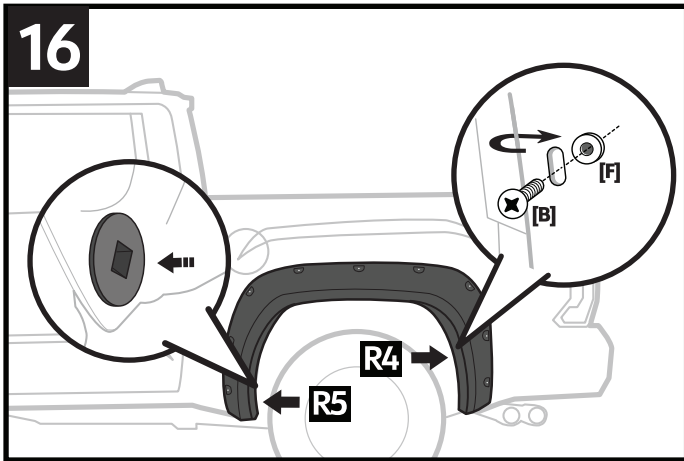

16. **R4** - Take the supplied **Spacer [F]** then slide it in between the Fender Flare and the Body Panel to fill the gap. Then use the supplied **Long Screw [B]** to secure the Fender and Spacer.  
**R5** - reuse the factory plug removed from **STEP 13**.

⌚ Adjust the position of the flare and then press firmly into the flare before tightening each screw in the sequence from **R1** to **R7** for the best fit.

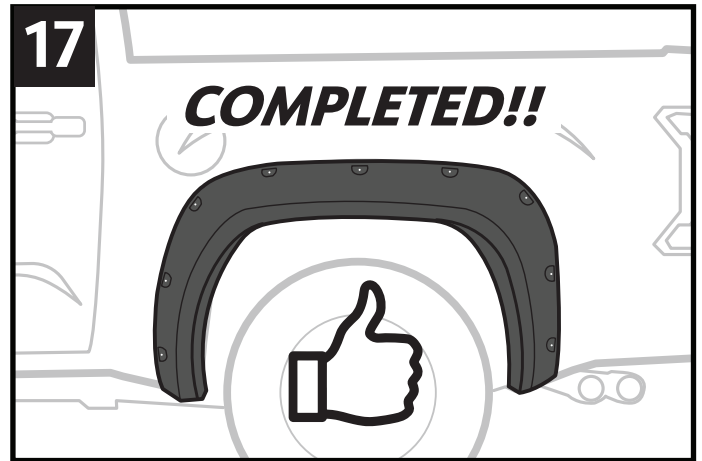

17. Make any additional adjustments to improve positioning of the flare. Follow the screw sequence number while tightening.

## Edge Trim Tool Usage (Optional):

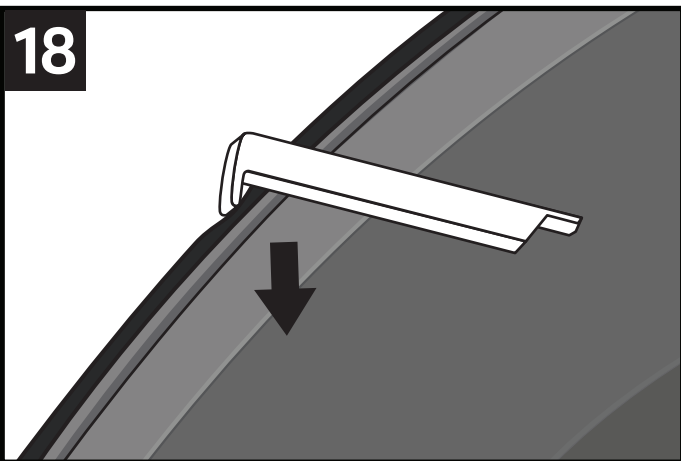

18. If needed, use supplied **Edge Trim Tool [I]** to trim outer edge by inserting the curved end, then sliding around the entire trim from one end to the other.

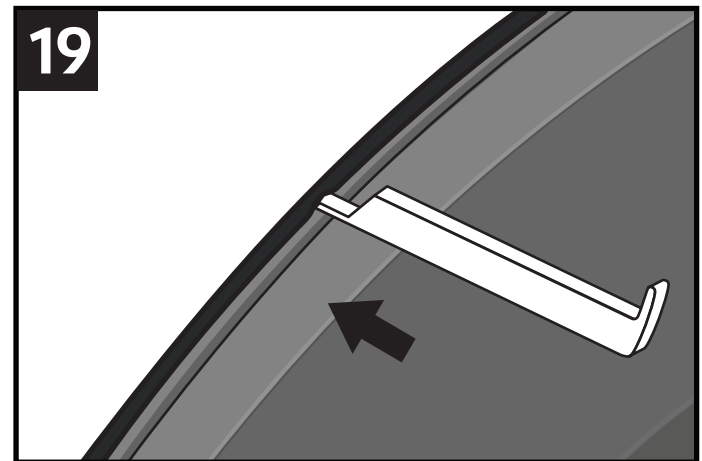

19. If needed, use supplied **Edge Trim Tool [I]** to trim inner edge by inserting the straight end, then sliding around the entire trim from one end to the other.

## Final Result:

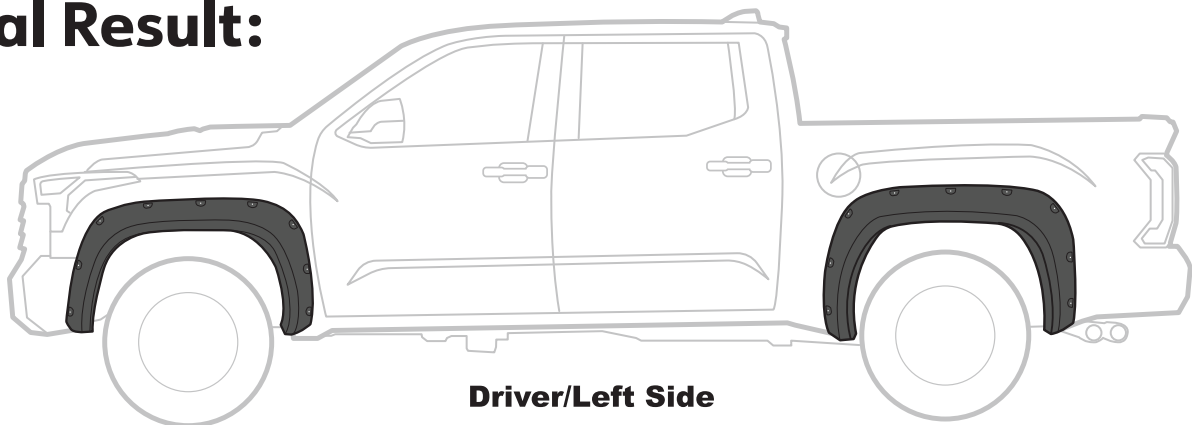

Driver/Left Side

Note: Above image is for reference ONLY, final result may vary.