



TYGER[®]

TYGER LIGHT CLAMPS

TG-GD2U28888:

Fit on 2.5inch round light bars only.

Before Installation

REMOVE CONTENTS FROM BOX. VERIFY ALL PARTS ARE PRESENT. READ INSTRUCTIONS CAREFULLY BEFORE STARTING INSTALLATION.

Parts List

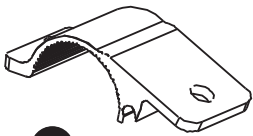

x2

Upper Clamp Mounts



x2

Plastic Rings



x2

Lower Clamp Mount

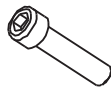

x2

6mm x 20 Button Head Bolts



x2

6mm Flat Washers

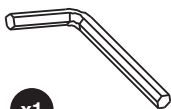

x1

4mm Wrench

STEP 1

Wrap (1) plastic ring around the tube in the approximate desired location, (Figure 1).

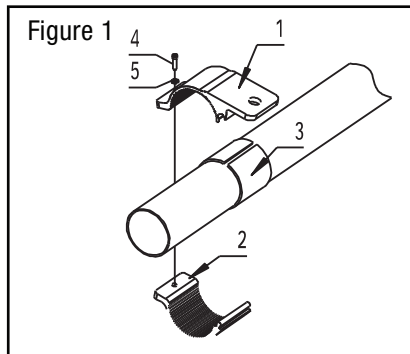

STEP 2

Slide the Lower Clamp Mount into the slot in the Upper Clamp Mount. Wrap the Upper and Lower Clamp Mount around the plastic ring, (Figure 1).

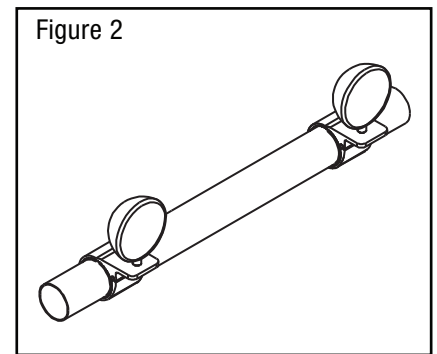

STEP 3

Insert (1) 6mm Button Head Bolt and (1) 6mm Flat Washer into and through the Upper Clamp and into the Lower Clamp Mount. Do not fully tighten at this time.

STEP 4

Attach the light to the Clamp Mount, (Figure 2). Please check the size of holes which are used for installation of lights before you purchase or choose lights.

STEP 5

Repeat Steps 1-4 to install the 2nd Clamp Mount. Move lights and Mounts to the desired position.

STEP 6

Follow light manufacturer's instructions to wire the light to the vehicle's electrical system.

STEP 7

Do periodic inspections to the installation to make sure that all hardware is secure and tight.