



TYGER HITCH

TG-HC2J003B

BEFORE INSTALLATION

READ INSTRUCTIONS CAREFULLY BEFORE STARTING INSTALLATION. REMOVE CONTENTS FROM BOX AND VERIFY ALL PARTS ARE PRESENT. FAILURE TO IDENTIFY DAMAGE BEFORE INSTALLATION COULD LEAD TO A REJECTION OF ANY CLAIM. IF MISSING PARTS OR ANY DAMAGE FOUND, PLEASE TAKE A PICTURE FOR THE CLAIM PURPOSE. TO FILE YOUR CLAIM, PLEASE VISIT: WWW.TYGERAUTO.COM/CONTACT

TORQUE VALUES

Fastener Size	Class 8.8 Torque (ft-lbs)	Class 10.9 Torque (ft-lbs)
6mm	6-7	6-7
8mm	15-16	22-23
10mm	31-32	44-45
12mm	54-55	78-79
14mm	87-88	125-126

Parts List

- x1 Receiver Towing Hitch
- x1 TYGER Hitch Plug
- x1 Trailer Wiring Harness Bracket
- x4 12-1.75mm x 120mm Hex Bolts
- x6 12mm x 32mm x 3mm Flat Washers
- x2 12mm Lock Washers
- x2 12-1.75mm Nylon Lock Nuts

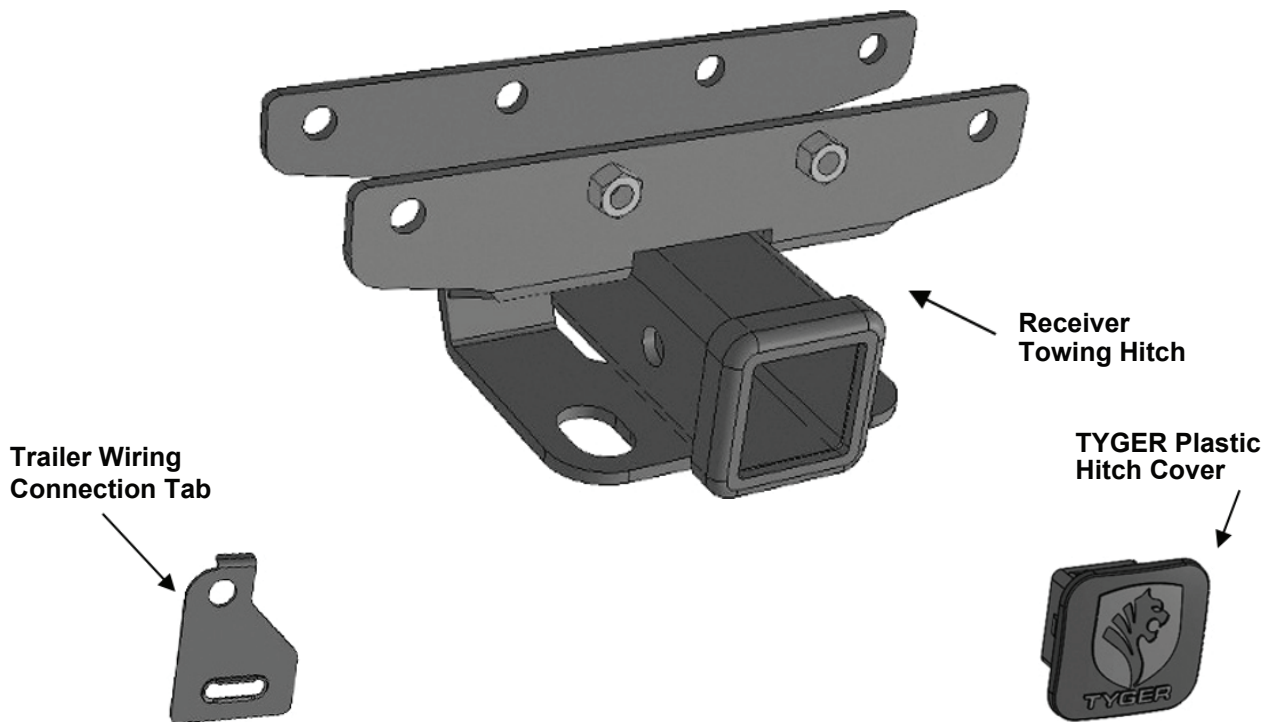



PROCEDURE:

REMOVE CONTENTS FROM BOX. VERIFY ALL PARTS ARE PRESENT. READ INSTRUCTIONS CAREFULLY BEFORE STARTING INSTALLATION.

STEP 1

Locate the frame crossmember behind the rear bumper (Figs 1 & 2). On models equipped with diesel DEF tank, loosen the (2) hex bolts attaching the rear of the DEF tank to the crossmember (Fig 2).

NOTE: Only loosen the hex bolts enough to allow room to insert the included long hex bolts to attach the Hitch as described in **STEP 2**.

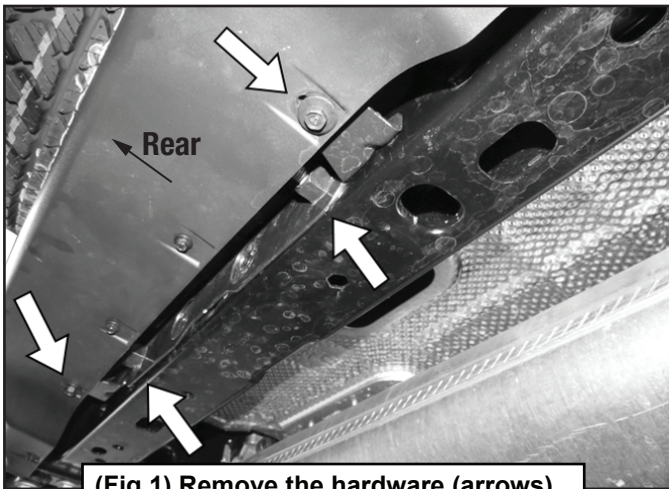

(Fig 1) Remove the hardware (arrows) attaching the L-support bracket, (if equipped), to the bottom of the bumper and to the crossmember

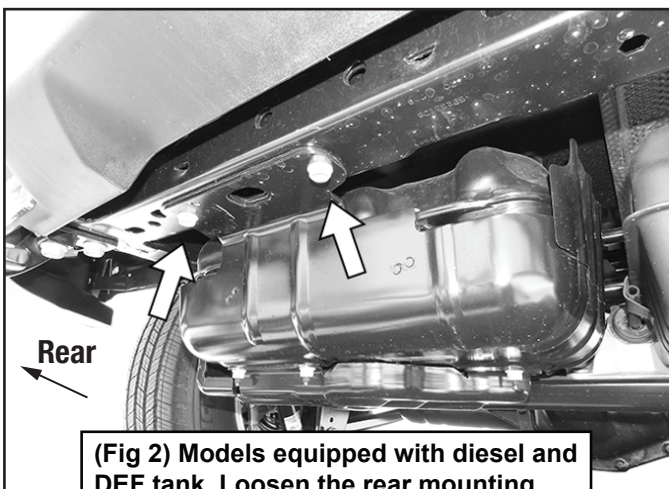

(Fig 2) Models equipped with diesel and DEF tank. Loosen the rear mounting bolts (arrows) to provide access for Hitch hardware (see figures 5 & 9)

STEP 2

Determine if the bumper is equipped with an L-shaped bumper support bracket connecting the bottom of the bumper to the back of the crossmember (Figs 1 & 3).

NOTE: Must reuse (2) 12mm fine thread factory hex bolts to attach L-support bracket to outer holes (arrows) on Hitch

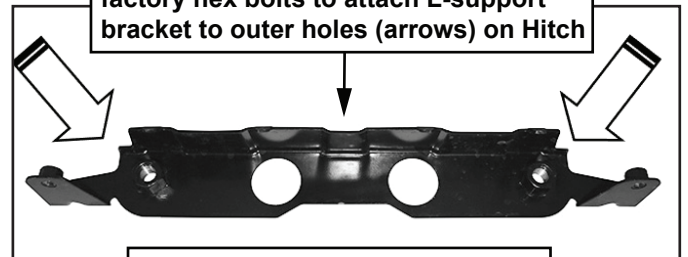

(Fig 3) L-bumper support bracket

Models equipped with an L-shaped support bracket:

a. Remove the factory bolts attaching the support bracket to the crossmember and bottom of bumper (Fig 1). Next, loosen but do not remove the (4) factory bumper bolts (Fig 4).



(Fig 4) Loosen the factory bumper bolts, (2 per side).

b. Select the Receiver Hitch. Hold the Receiver Hitch up to and over the crossmember. Insert the Hitch between the crossmember and the support bracket.

NOTE: The inner welded nuts on the Hitch will be facing the rear.

c. Slide the mounting tab for the Trailer Connection Bracket between the driver/left outer mounting hole on the Hitch and the L-support bracket (Figs 5 & 6).

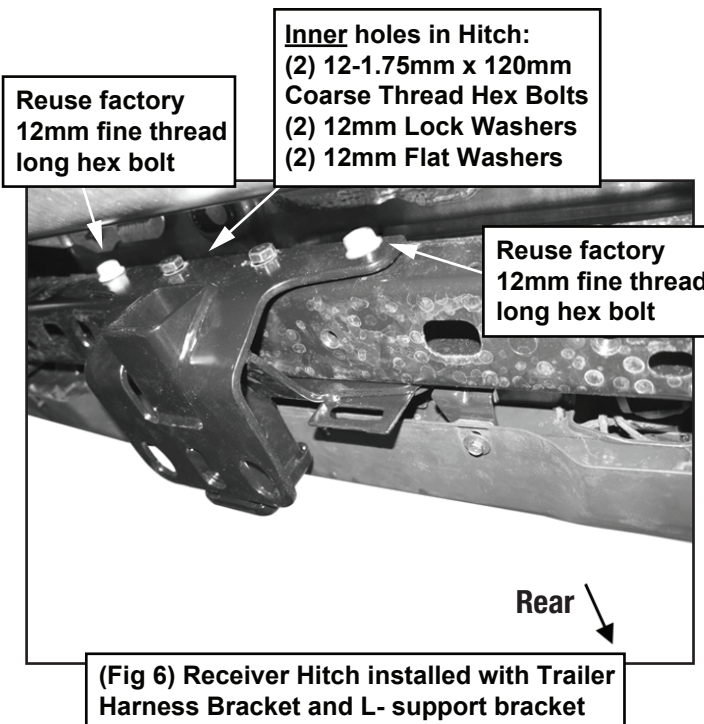
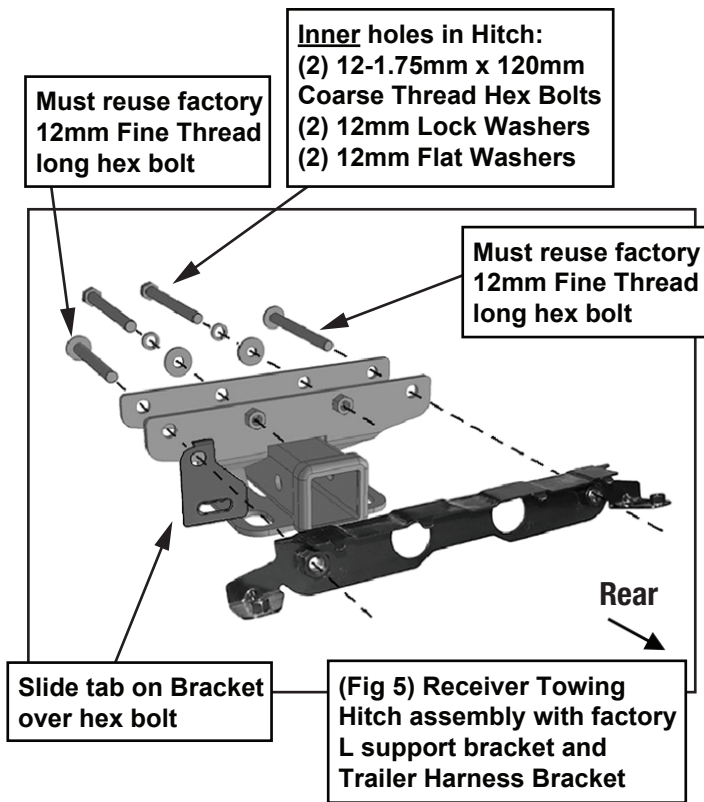

d. Insert the included (2) 12-1.75mm x 120mm Coarse Thread Hex Bolts, (2) 12mm Lock Washers and (2) 12mm Flat Washers through the (2) inner mounting holes in the Hitch, through the frame and into the welded nuts on the Hitch (Figs 5 & 6). DO NOT tighten hardware.

e. Line up the factory L-support bracket over the weld nuts on the Receiver Hitch (Fig 5).

f. Select (2) **factory "fine thread" hex bolts for reuse**. Insert the (2) factory long bolts through the outer holes in the Hitch, through the crossmember and into the welded nuts on the L-support bracket (Figs 5 & 6).

IMPORTANT: Only use the long factory fine thread hex bolts to attach the L-support bracket to the back of the Hitch. **DO NOT USE** the included 12-1.75mm x 120mm Coarse Thread Hex Bolts or damage to the L-support bracket may result.

NOTE: All Bolts will face towards the rear end of the vehicle. DO NOT tighten hardware at this time.

g. Reattach the bottom of the bumper to the factory L-support bracket. Adjust the bumper and fully tighten all hardware.

Models without L-support bracket:

a. Loosen but do not remove the (4) factory bumper bolts (Fig 4).

b. Hold the Receiver Hitch up to the crossmember. On some model-years, there may be (2) factory hex bolts and (1) double nut plate attached to the crossmember (Figs 7 & 8). Remove the hex bolts and double nut plate, this hardware will not be reused.

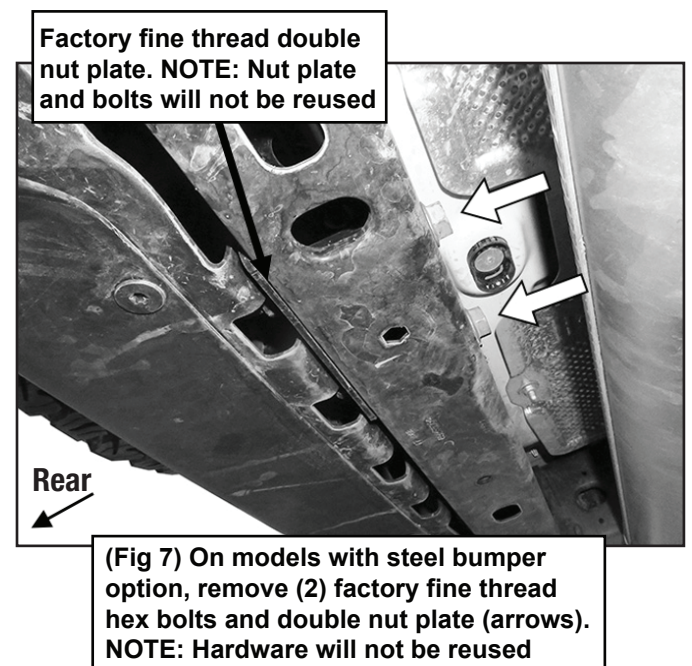



(Fig 8) Factory fine thread double nut plate. NOTE: Nut plate will not be reused

c. Line up the holes in the Hitch with the crossmember.

NOTE: The inner welded nuts on the Hitch will be facing the rear.

d. Insert the included (2) 12-1.75mm x 120mm Coarse Thread Hex Bolts, (2) 12mm Lock Washers and (2) 12mm Flat Washers through the (2) inner mounting holes in the Hitch, the crossmember and into the welded nuts on the Hitch (Figs 9 & 10). DO NOT reuse the factory 12mm fine thread long hex bolts, if equipped. Snug but DO NOT tighten hardware at this time.

Inner holes in Hitch:	Outer holes in Hitch:
(2) 12-1.75mm x 120mm Coarse Thread Hex Bolts	(2) 12-1.75mm x 120mm Coarse Thread Hex Bolts
(2) 12mm Lock Washers	(4) 12mm Flat Washers
(2) 12mm Flat Washers	(2) 12mm Nylon Lock Nuts

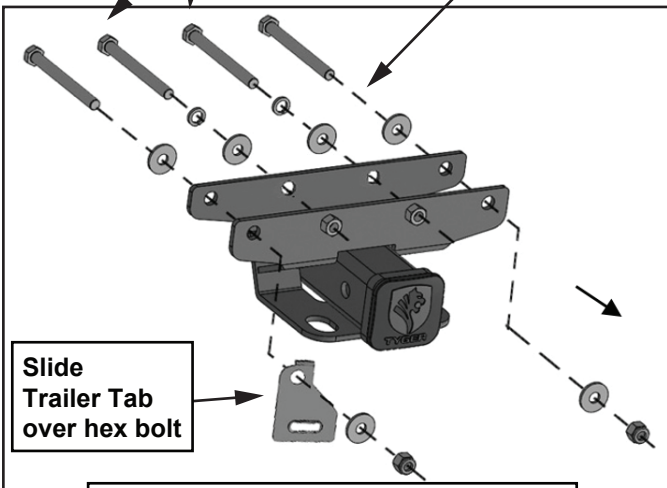

(Fig 9) Receiver Hitch assembly with Trailer Harness Bracket installation on model with steel bumper option (no bumper L-support bracket)



(Fig 10) Hitch installed with Trailer Harness Bracket on model with steel bumper option

- e. Next, insert (2) 12-1.75mm x 120mm Coarse Thread Hex Bolts and (2) 12mm Flat Washers through the outer holes in the Hitch, through the crossmember and out through the Hitch (Figs 9 & 10).
- f. If installing the Trailer Connection Tab, slide the Tab over the end of the driver/left outer Hex Bolt (Figs 9 & 10).
- g. Secure the (2) outer 12-1.75mm Coarse Thread Hex Bolts to the Hitch with (2) 12mm Flat Washers and (2) 12mm Nylon Lock Nuts (Figs 9 & 10).
- h. Center and adjust the Receiver Hitch and fully tighten all hardware.

STEP 3

Models equipped with diesel, retighten the (2) hex bolts attaching the DEF tank, (see **STEP 1**, Fig 2).

STEP 4

Push the trailer harness into the Trailer Connection Tab, if installed.

STEP 5

Do periodic inspections of the installation to make sure that all hardware is secure and tight.