



# TYGER KOBRA

TG-KB2D25006

Scan to Download the Latest Digital Version



## BEFORE INSTALLATION

READ INSTRUCTIONS CAREFULLY BEFORE STARTING INSTALLATION. REMOVE CONTENTS FROM BOX AND VERIFY ALL PARTS ARE PRESENT. FAILURE TO IDENTIFY DAMAGE BEFORE INSTALLATION COULD LEAD TO A REJECTION OF ANY CLAIM. IF MISSING PARTS OR ANY DAMAGE FOUND, PLEASE TAKE A PICTURE FOR THE CLAIM PURPOSE. TO FILE YOUR CLAIM, PLEASE VISIT: [WWW.TYGERAUTO.COM/CONTACT](http://WWW.TYGERAUTO.COM/CONTACT)

## TORQUE VALUES

Fastener Size	Class 8.8 Torque (ft-lbs)	Class 10.9 Torque (ft-lbs)
6mm	6-7	6-7
8mm	15-16	22-23
10mm	31-32	44-45
12mm	54-55	78-79
14mm	87-88	125-126

- |  |  |  |
|--|--|--|
| <b>x1</b> Driver/Left Tyger Kobra                            | <b>x1</b> Driver/Left Rear Support Bracket [F]     | <b>x12</b> 8-1.25mm x 25mm Combination Bolts |
| <b>x1</b> Passenger/Right Tyger Kobra                        | <b>x1</b> Passenger/Right Rear Support Bracket [H] | <b>x24</b> 8mm x 24mm x 2mm Flat Washers     |
| <b>x2</b> Driver/Left Front/Center Mounting Brackets [A]     | <b>x6</b> 8-1.25mm x 30mm T-shaped Bolt Plates     | <b>x12</b> 8mm Lock Washers                  |
| <b>x2</b> Passenger/Right Front/Center Mounting Brackets [C] | <b>x6</b> 8mm Plastic Retainers                    | <b>x6</b> 8mm Hex Nuts                       |
| <b>x1</b> Driver/Left Rear Mounting Bracket [B]              | <b>x12</b> 6-1.0mm x 25mm Hex Bolts                | <b>x6</b> 8mm Nylon Lock Nuts                |
| <b>x1</b> Passenger/Right Rear Mounting Bracket [D]          | <b>x24</b> 6mm x 22mm x 2mm Flat Washers           |  |
| <b>x2</b> Driver/Left Front/Center Support Brackets [E]      | <b>x12</b> 6mm Nylon Lock Nuts                     |  |
| <b>x2</b> Passenger/Right Front/Center Support Brackets [G]  | <b>x18</b> 8-1.25mm x 30mm Hex Bolts               |  |

## Parts List

**ATTENTION:** Refer to **D** and **P** labelling on the side of the tubes to determine Driver and Passenger TYGER Kobra

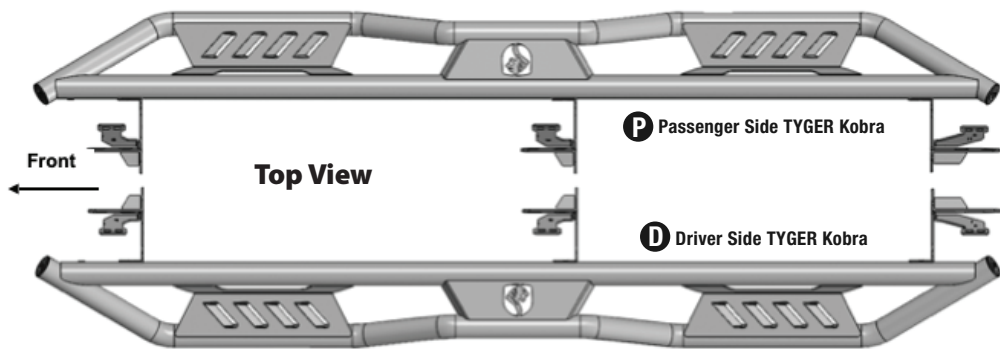

- |   |  |   |  |
|---|--|---|--|
| <b>x2 [A]</b><br>Driver/Left Front/Center Mounting Brackets | <b>x1 [B]</b><br>Driver/Left Rear Mounting Bracket | <b>x2 [C]</b><br>Passenger/Right Front/Center Mounting Brackets | <b>x1 [D]</b><br>Passenger/Right Rear Mounting Bracket |
| <b>x2 [E]</b><br>Driver/Left Front/Center Support Brackets  | <b>x1 [F]</b><br>Driver/Left Rear Support Bracket  | <b>x2 [G]</b><br>Passenger/Right Front/Center Support Brackets  | <b>x1 [H]</b><br>Passenger/Right Rear Support Bracket  |

- Hex Bolt**
- x12** 6-1.0mm x 25mm Hex Bolts
- x18** 8-1.25mm x 30mm Hex Bolts
- Flat Washer**
- x24** 6mm x 22mm x 2mm Flat Washers
- x24** 8mm x 24mm x 2mm Flat Washers

- Nylon Lock Nut**
- x12** 6mm Nylon Lock Nuts
- x6** 8mm Nylon Lock Nuts
- Combo Bolt**
- x12** 8mm x 1.25mm x 25mm Combo Bolts
- Lock Washers**
- x12** 8mm Lock Washers
- 8mm Hex Nuts**
- x6** 8mm Hex Nuts
- 8mm Plastic Retainer**
- x6** 8mm Plastic Retainers
- 8-1.25mm x 30mm T-shaped Bolt Plates**
- x6** 8-1.25mm x 30mm T-shaped Bolt Plates

Reference the letters printed on the brackets to determine mounting locations

**Top View**

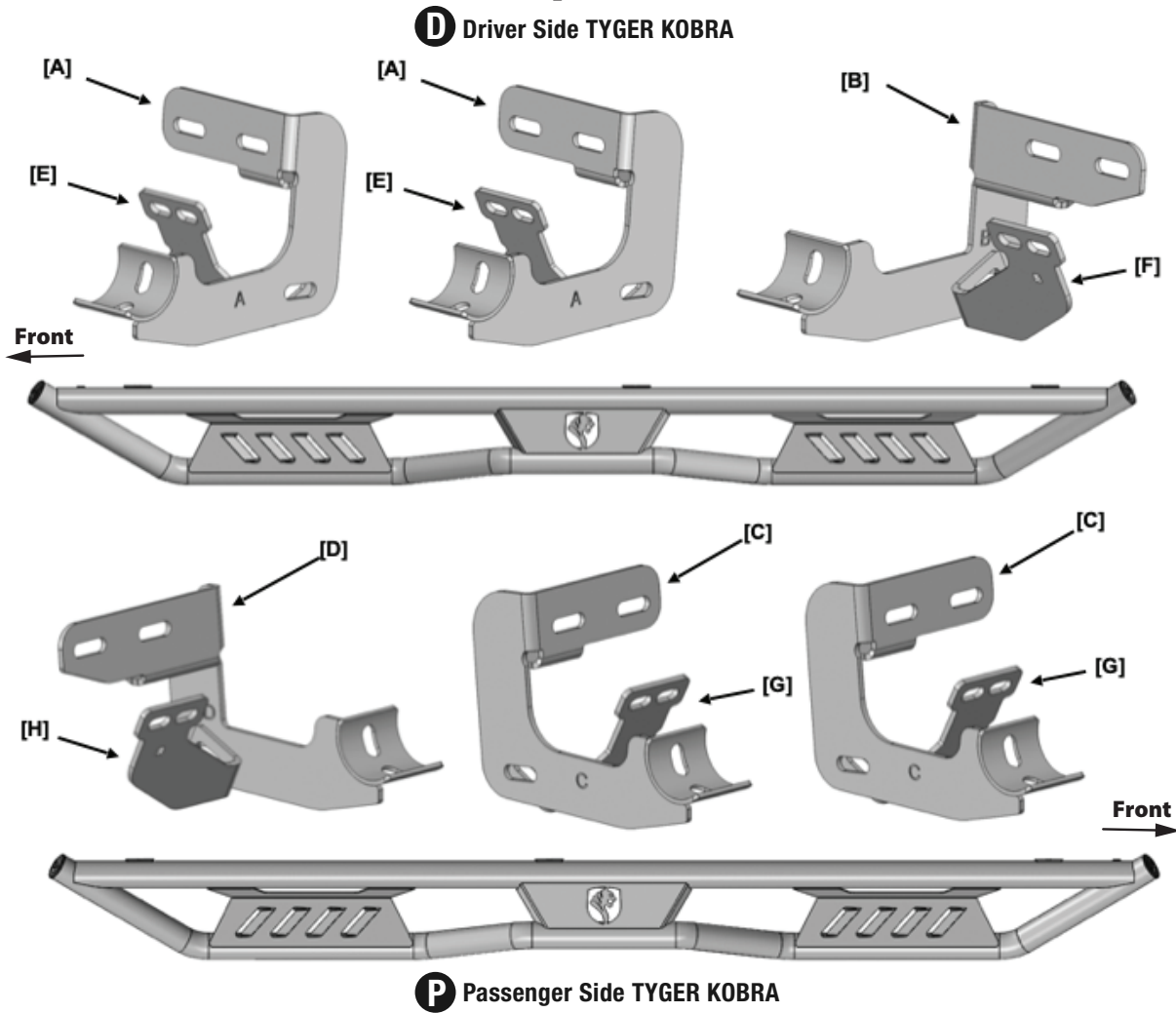

**Bottom View**

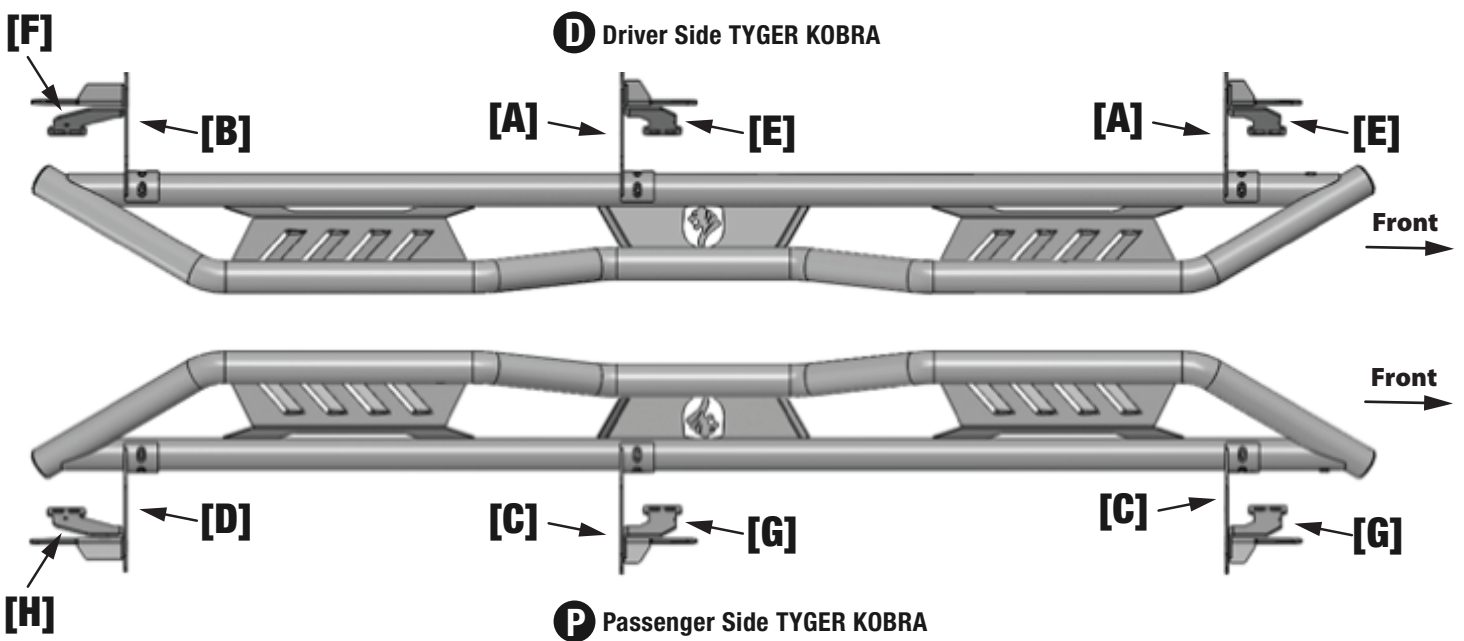

## TOOLS REQUIRED

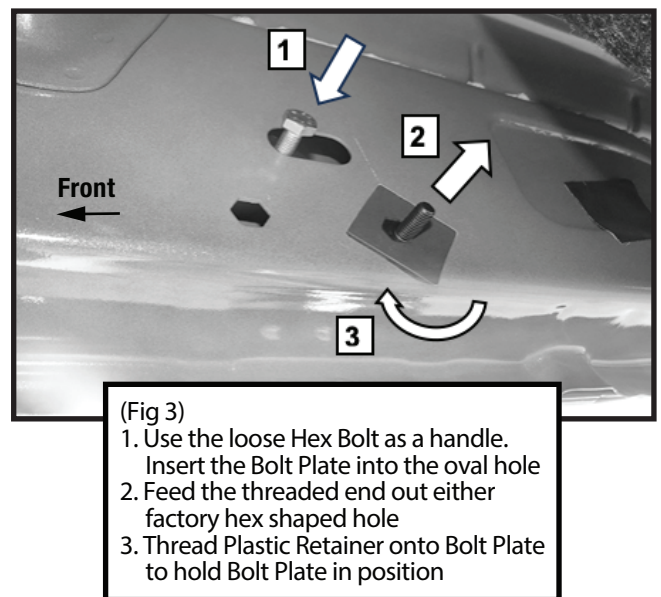
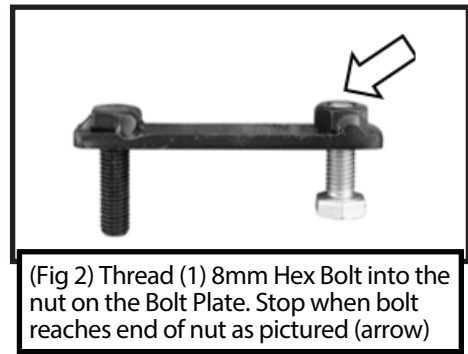
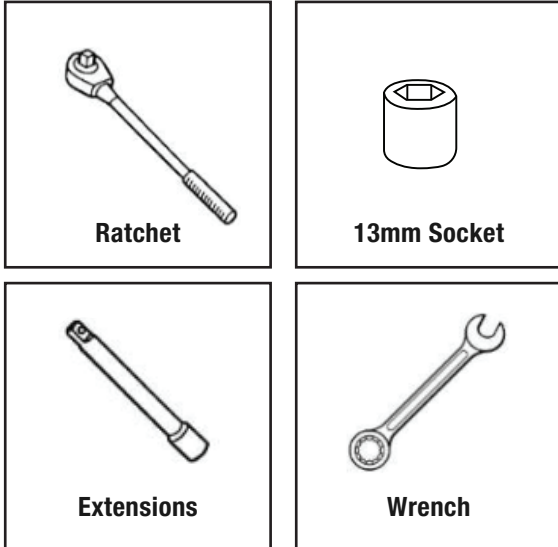

## STEP 1 MOUNTING BRACKETS

Follow (Fig 1 – 20) to attach the Mounting Brackets to the Passenger/Right Side starting at the Front. Then add Support Brackets to the Mounting Brackets. Ensure hardware is hand tightened at this point.

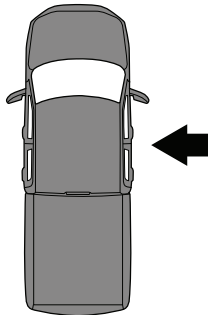

**Passenger-side Front Mounting Area**

For model years **2009-mid 2015:**

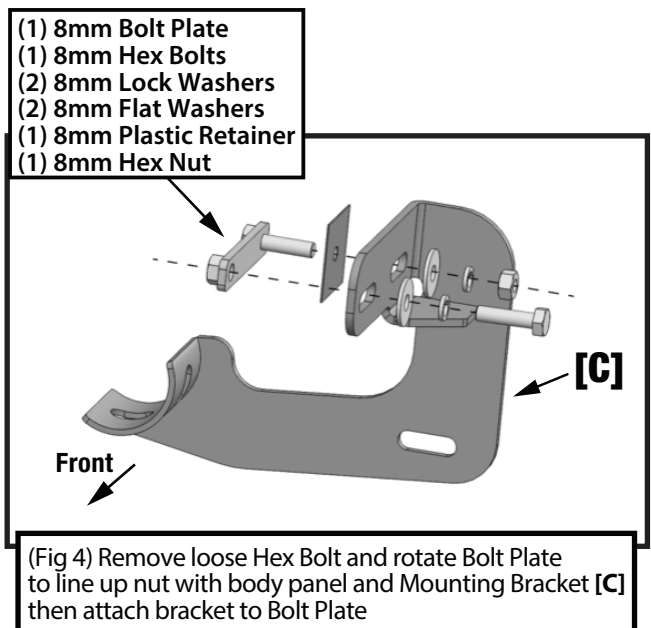
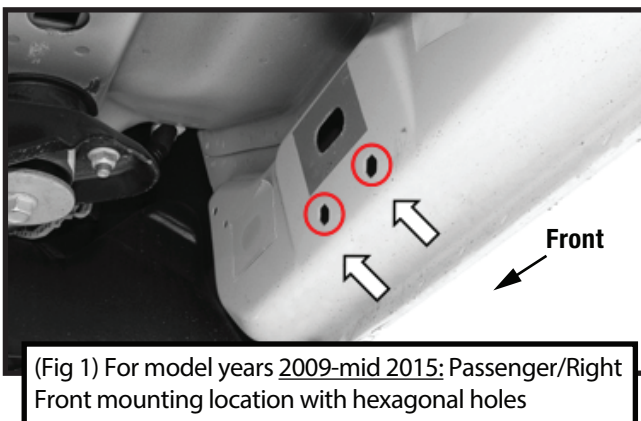

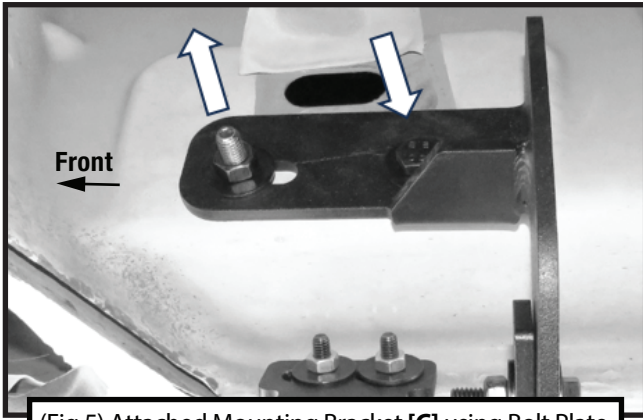

(Fig 5) Attached Mounting Bracket [C] using Bolt Plate

**IMPORTANT:** 2009-2012 models without holes in pinch weld will require drilling 1/4" holes through pinch weld to attach support bracket. Complete installation and level Drop Step before drilling holes for support brackets.

For model years **Mid 2015 - on:**

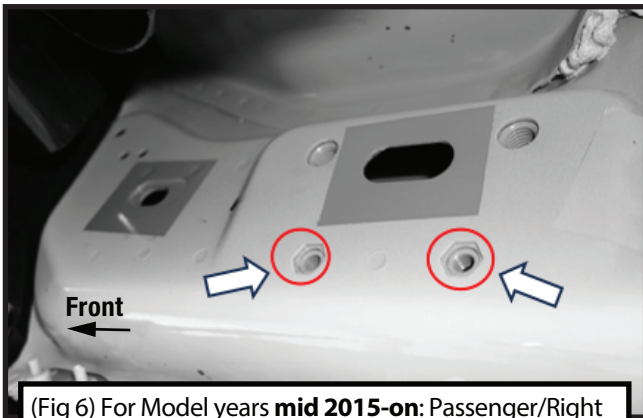

(Fig 6) For Model years **mid 2015-on:** Passenger/Right Front mounting location with threaded mounting holes

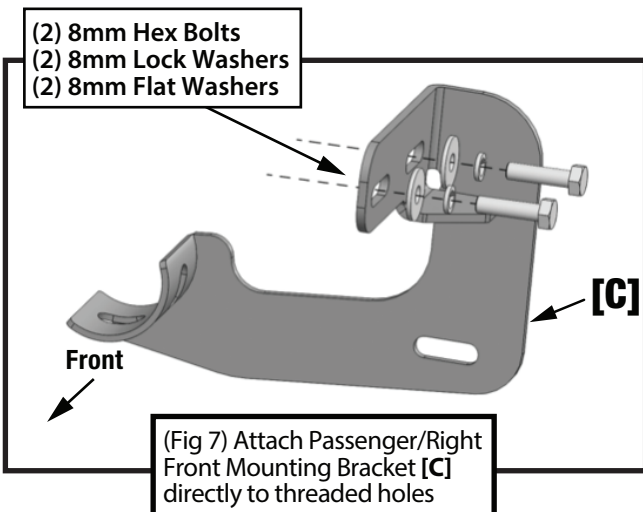

(Fig 7) Attach Passenger/Right Front Mounting Bracket [C] directly to threaded holes

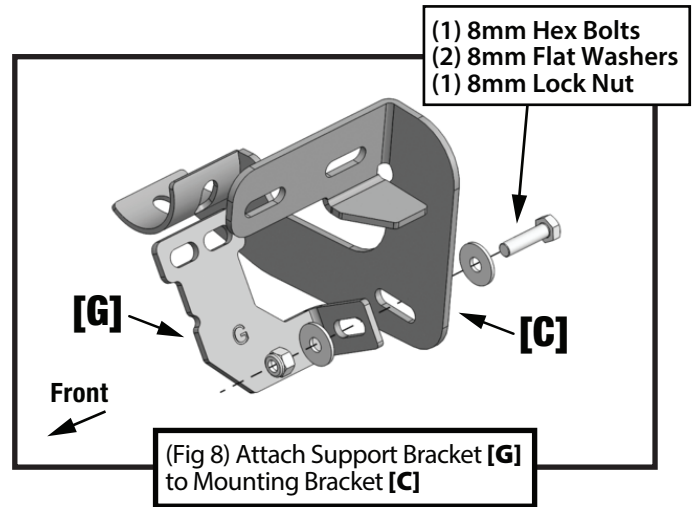

(Fig 8) Attach Support Bracket [G] to Mounting Bracket [C]

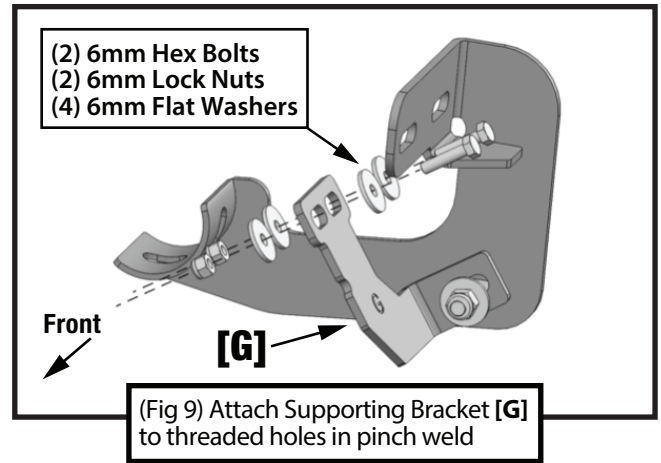

(Fig 9) Attach Supporting Bracket [G] to threaded holes in pinch weld

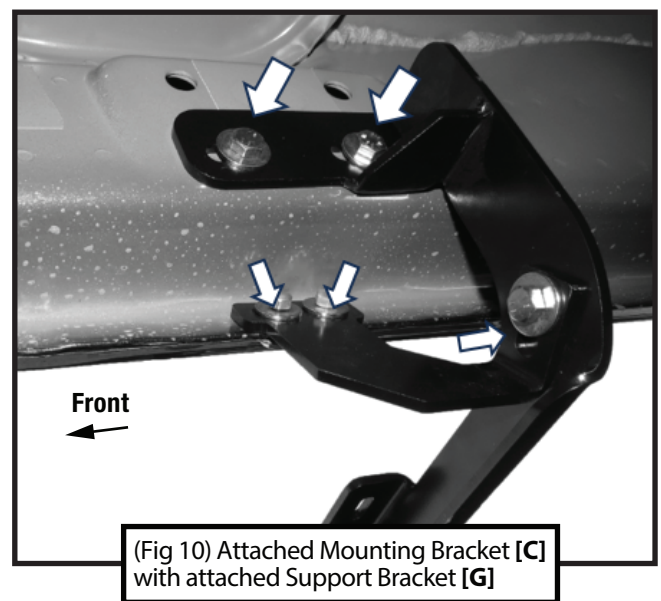

(Fig 10) Attached Mounting Bracket [C] with attached Support Bracket [G]

**Passenger-side Center Mounting Area**

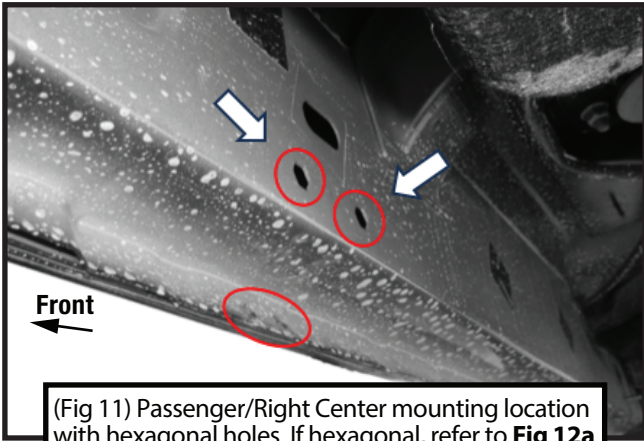

(Fig 11) Passenger/Right Center mounting location with hexagonal holes. If hexagonal, refer to Fig 12a. If threaded, continue with Fig 12b

- (1) 8mm Bolt Plate
- (1) 8mm Hex Bolts
- (2) 8mm Lock Washers
- (2) 8mm Flat Washers
- (1) 8mm Plastic Retainer
- (1) 8mm Hex Nut

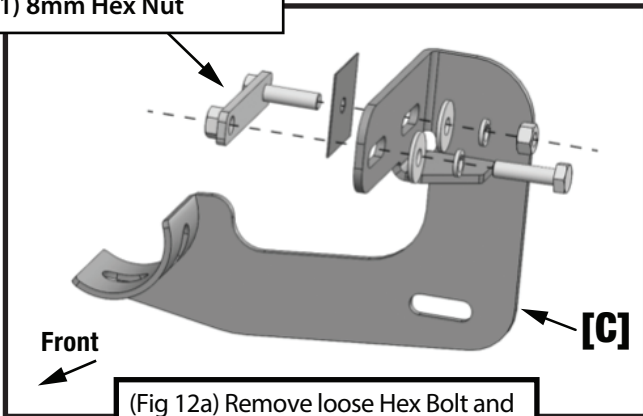

(Fig 12a) Remove loose Hex Bolt and rotate Bolt Plate to line up nut with body panel and Mounting Bracket [C] then attach bracket to Bolt Plate

- (2) 8mm Hex Bolts
- (2) 8mm Lock Washers
- (2) 8mm Flat Washers

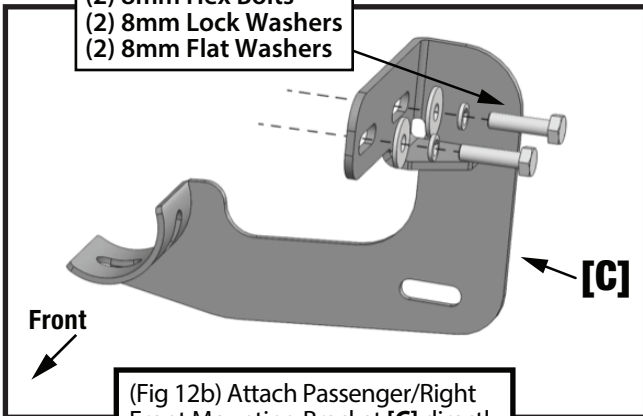

(Fig 12b) Attach Passenger/Right Front Mounting Bracket [C] directly to threaded holes

- (1) 8mm Hex Bolts
- (2) 8mm Flat Washers
- (1) 8mm Lock Nut

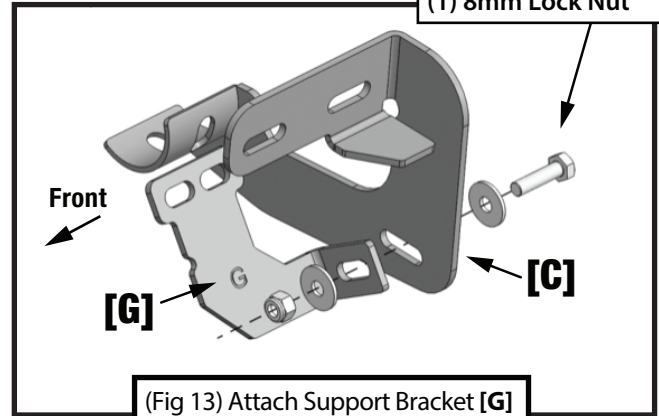

(Fig 13) Attach Support Bracket [G] to Mounting Bracket [C]

- (2) 6mm Hex Bolts
- (2) 6mm Lock Nuts
- (4) 6mm Flat Washers

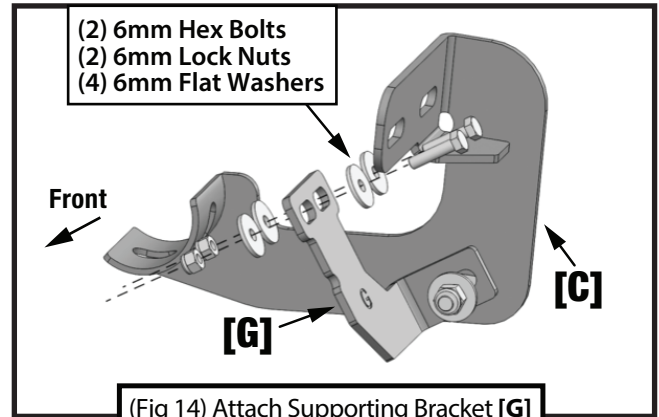

(Fig 14) Attach Supporting Bracket [G] to threaded holes in pinch weld

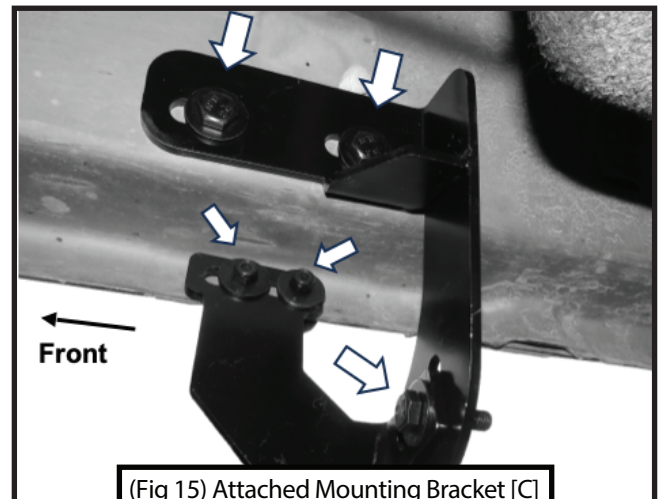

(Fig 15) Attached Mounting Bracket [C] with attached Support Bracket [G]

**IMPORTANT:** 2009-2012 models without holes in pinch weld will require drilling 1/4" holes through pinch weld to attach support bracket. Complete installation and level Drop Step before drilling holes for support brackets.

**Passenger-side Rear Mounting Area**

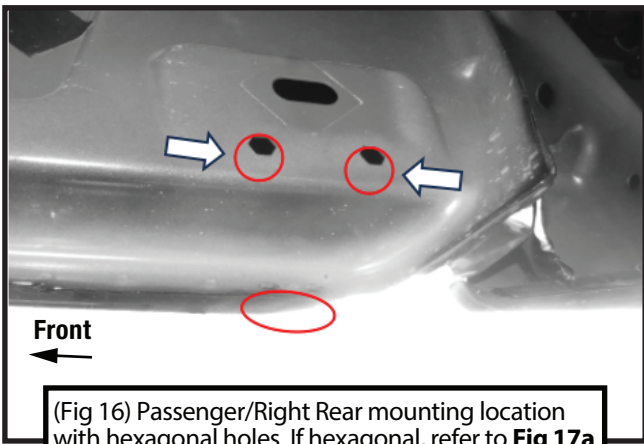

(Fig 16) Passenger/Right Rear mounting location with hexagonal holes. If hexagonal, refer to Fig 17a. If threaded, continue with Fig 17b

- (1) 8mm Bolt Plate
- (1) 8mm Hex Bolts
- (2) 8mm Lock Washers
- (2) 8mm Flat Washers
- (1) 8mm Plastic Retainer
- (1) 8mm Hex Nut

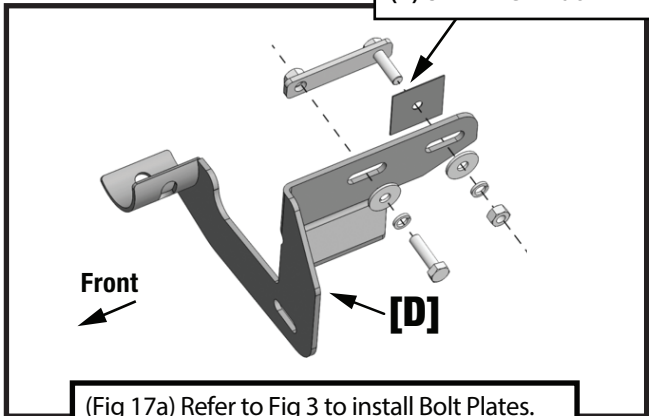

(Fig 17a) Refer to Fig 3 to install Bolt Plates. Remove loose Hex Bolt and rotate Bolt Plate to line up nut with body panel and Mounting Bracket [D] then attach bracket to Bolt Plate

- (2) 8mm Hex Bolts
- (2) 8mm Lock Washers
- (2) 8mm Flat Washers

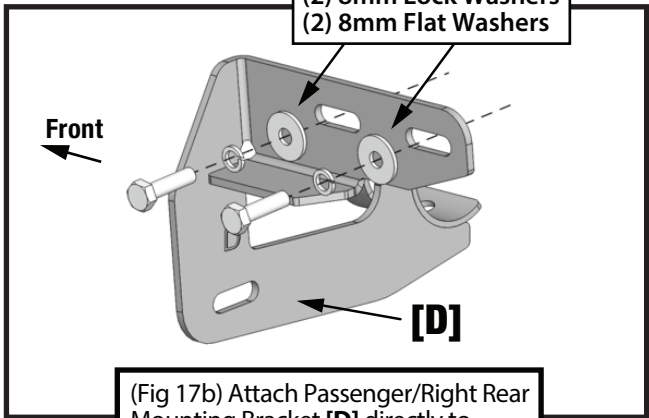

(Fig 17b) Attach Passenger/Right Rear Mounting Bracket [D] directly to threaded holes

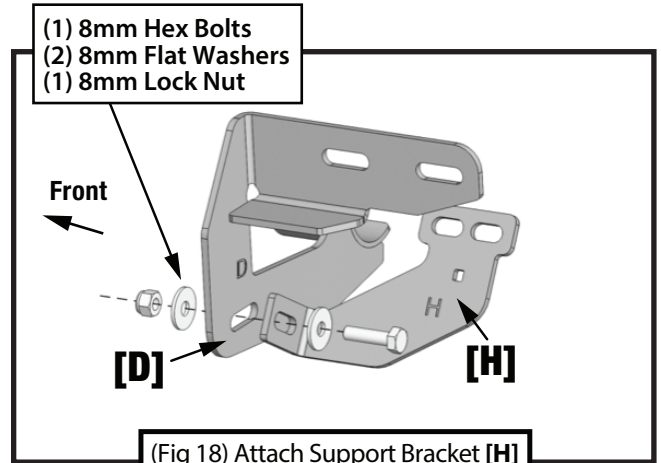

(Fig 18) Attach Support Bracket [H] to Mounting Bracket [D]

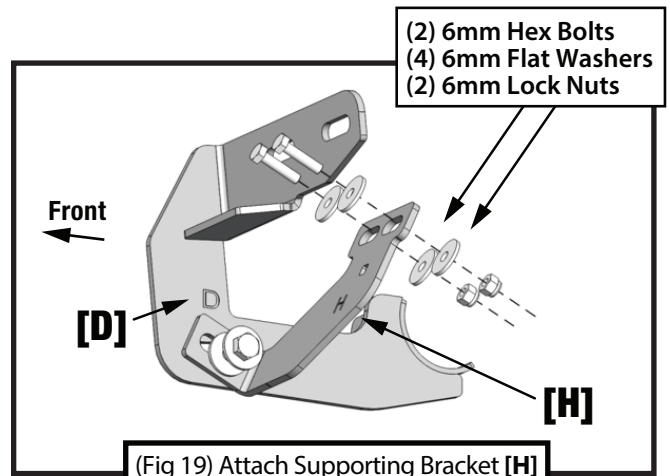

(Fig 19) Attach Supporting Bracket [H] to threaded holes in pinch weld

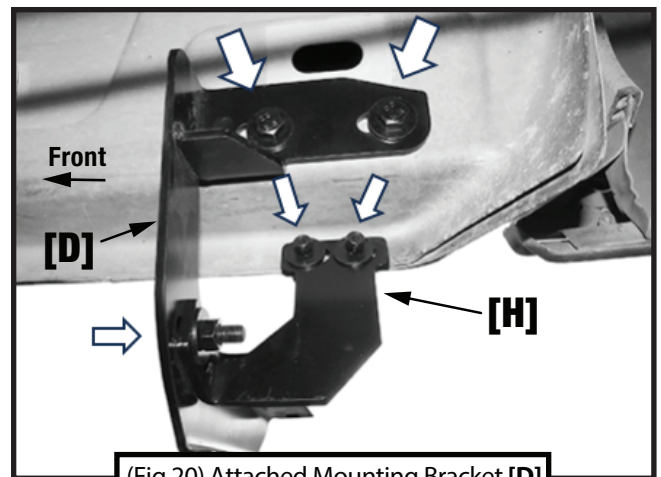

(Fig 20) Attached Mounting Bracket [D] with attached Support Bracket [H]

**IMPORTANT:** 2009-2012 models without holes in pinch weld will require drilling 1/4" holes through pinch weld to attach support bracket. Complete installation and level Drop Step before drilling holes for support brackets.

## STEP 2 MOUNTING RUNNING BOARD

Follow (Fig 21-22) to install the TYGER Kobra Drop Step to the Passenger/Right side. Ensure hardware is hand tightened.

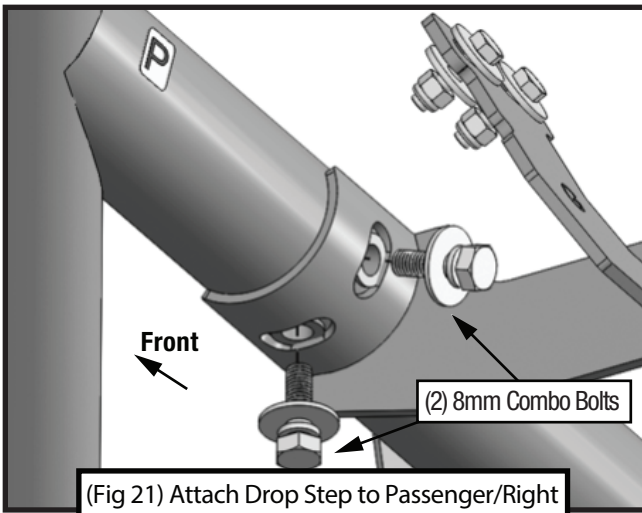

(Fig 21) Attach Drop Step to Passenger/Right Mounting Brackets (C, D)

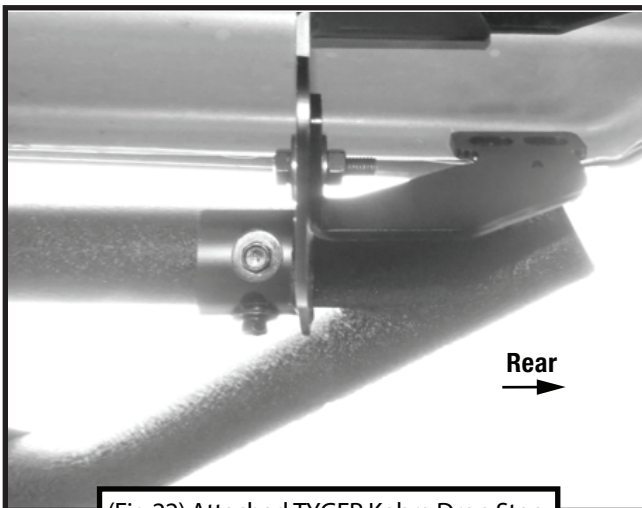

(Fig 22) Attached TYGER Kobra Drop Step

## STEP 3 DRIVER SIDE

Repeat **STEPS 1-2** for driver side installation.  
 Use Front and Center Mounting Brackets [A] instead of [C];  
 Use Front and Center Support Brackets [E] instead of [G];  
 Use Rear Mounting Bracket [B] instead of [D];  
 Use Rear Support Bracket [F] instead of [H].

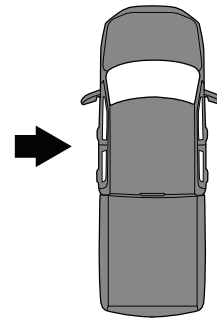

## STEP 4

Ensure Tyger Kobra Drop Step is level and straightened, then tighten all fasteners. Installation is complete. Perform periodic inspections to the installation to make sure that all hardware is secure and tight.



Complete Installation