



# TYGER KOBRA

TG-KB2J25003

Scan to Download the Latest Digital Version



## BEFORE INSTALLATION

READ INSTRUCTIONS CAREFULLY BEFORE STARTING INSTALLATION. REMOVE CONTENTS FROM BOX AND VERIFY ALL PARTS ARE PRESENT. FAILURE TO IDENTIFY DAMAGE BEFORE INSTALLATION COULD LEAD TO A REJECTION OF ANY CLAIM. IF MISSING PARTS OR ANY DAMAGE FOUND, PLEASE TAKE A PICTURE FOR THE CLAIM PURPOSE. TO FILE YOUR CLAIM, PLEASE VISIT: [WWW.TYGERAUTO.COM/CONTACT](http://WWW.TYGERAUTO.COM/CONTACT)

## TORQUE VALUES

Fastener Size	Class 8.8 Torque (ft-lbs)	Class 10.9 Torque (ft-lbs)
6mm	6-7	6-7
8mm	15-16	22-23
10mm	31-32	44-45
12mm	54-55	78-79
14mm	87-88	125-126

- |   |  |  |
|---|--|--|
| <b>x1</b> Driver/Left Tyger Kobra                     | <b>x1</b> Driver/Left Support Bracket [G]                      | <b>x6</b> 10mm x 1.5mm x 30mm Hex Bolts        |
| <b>x1</b> Passenger/Right Tyger Kobra                 | <b>x1</b> Passenger/Right Support Bracket [I]                  | <b>x12</b> 10mm x 24mm x 2.2mm Flat Washers    |
| <b>x1</b> Driver/Left Front Mounting Bracket [A]      | <b>x2</b> Driver/Left Center and Rear Support Brackets [H]     | <b>x12</b> 8mm x 1.25mm x 25mm Hex Combo Bolts |
| <b>x1</b> Passenger/Right Front Mounting Bracket [D]  | <b>x2</b> Passenger/Right Center and Rear Support Brackets [J] | <b>x6</b> 8mm x 1.25mm x 35mm Hex Bolts        |
| <b>x1</b> Driver/Left Center Mounting Bracket [B]     | <b>x12</b> 6mm x 1.0mm x 25mm Hex Bolts                        | <b>x6</b> 8mm x 28mm x 3mm Flat Washers        |
| <b>x1</b> Passenger/Right Center Mounting Bracket [E] | <b>x24</b> 6mm x 22mm x 2mm Flat Washers                       | <b>x6</b> 8mm Lock Washers                     |
| <b>x1</b> Driver/Left Rear Mounting Bracket [C]       | <b>x12</b> 6mm Nylon Lock Nuts                                 |  |
| <b>x1</b> Passenger/Right Rear Mounting Bracket [F]   | <b>x6</b> 10mm Nylon Lock Nuts                                 |  |

## Parts List

**ATTENTION:** Refer to **D** and **P** labelling on the side of the tubes to determine Driver and Passenger TYGER Kobra

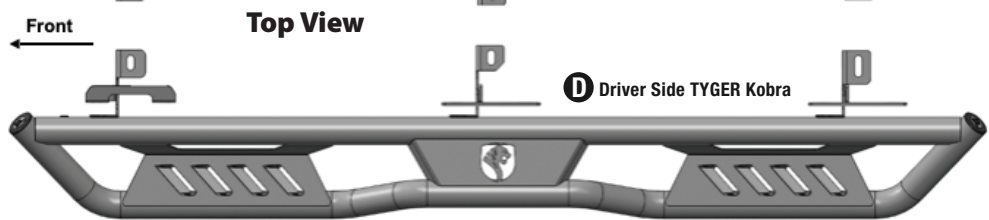
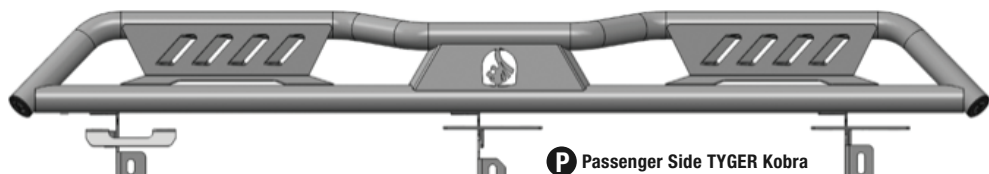

**x1 [A]**  
Driver/Left Front Mounting Bracket



**x1 [B]**  
Driver/Left Center Mounting Bracket



**x1 [C]**  
Driver/Left Rear Mounting Bracket



**x1 [D]**  
Passenger/Right Front Mounting Bracket



**x1 [E]**  
Passenger/Right Center Mounting Bracket



**x1 [F]**  
Passenger/Right Rear Mounting Bracket



**x1 [G]**  
Driver/Left Support Bracket

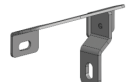

**x2 [H]**  
Driver/Left Center & Rear Support Brackets



**x1 [I]**  
Passenger/Right Front Support Bracket

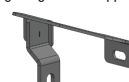

**x2 [J]**  
Passenger/Right Center & Rear Support Brackets



**Hex Bolt**

- x12** 6mm x 1.0mm x 25mm Hex Bolts
- x6** 10mm x 1.5mm x 30mm Hex Bolts
- x6** 8mm x 1.25mm x 35mm Hex Bolts

**Flat Washer**

- x24** 6mm x 22mm x 2mm Flat Washers
- x12** 10mm x 24mm x 2.2mm Flat Washers
- x6** 8mm x 28mm x 3mm Flat Washers

**Nylon Lock Nut**

- x12** 6mm Nylon Lock Nuts
- x6** 10mm Nylon Lock Nuts

**Lock Washers**

- x6** 8mm Lock Washers

**Combo Bolt**

- x12** 8mm x 1.25mm x 25mm Combo Bolts

Reference the letters printed on the brackets to determine mounting locations

**Top View**

**D** Driver Side TYGER Kobra

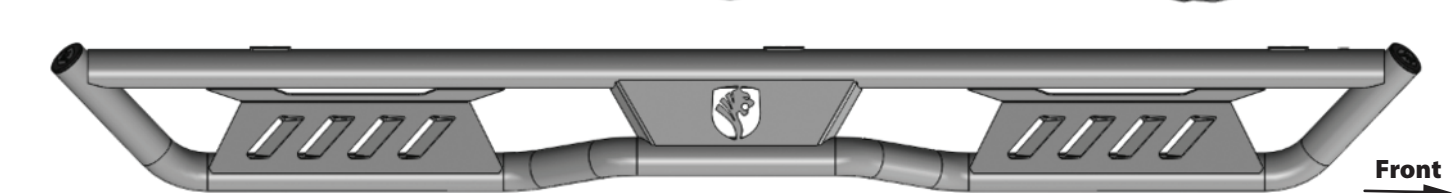
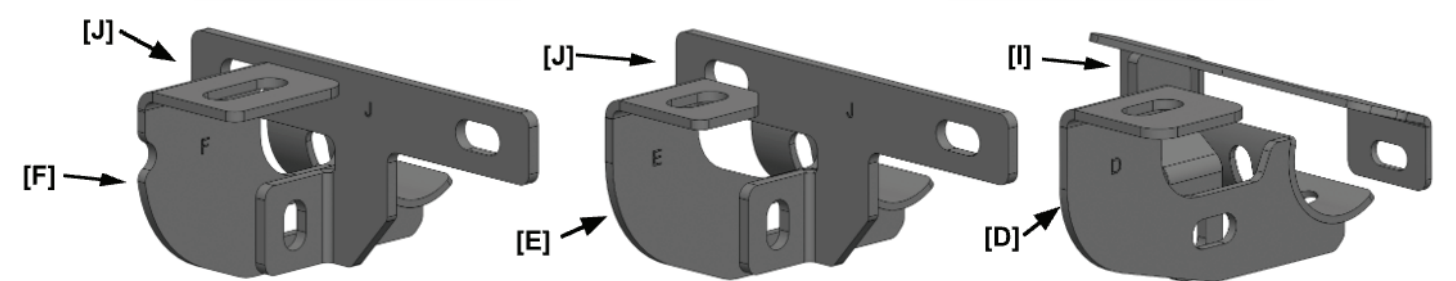
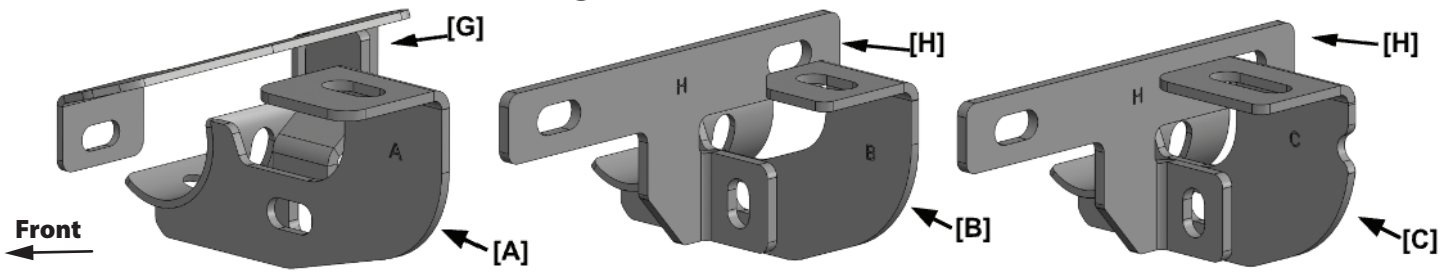

**P** Passenger Side TYGER Kobra

**Bottom View**

**D** Driver Side TYGER KOBRA

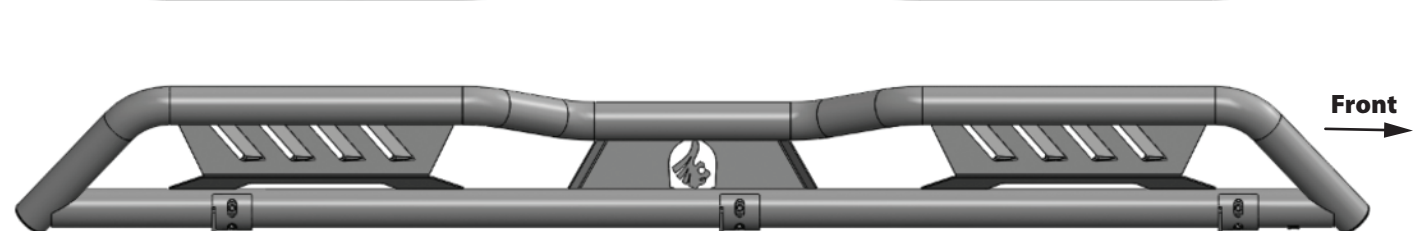
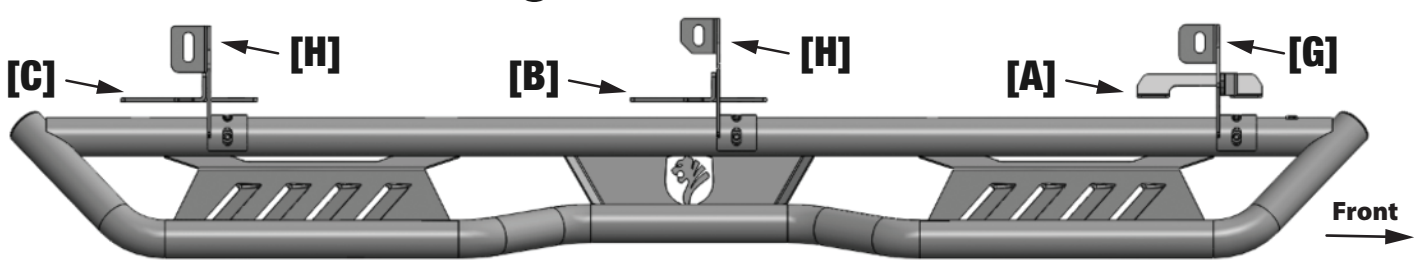

**P** Passenger Side TYGER KOBRA

## TOOLS REQUIRED

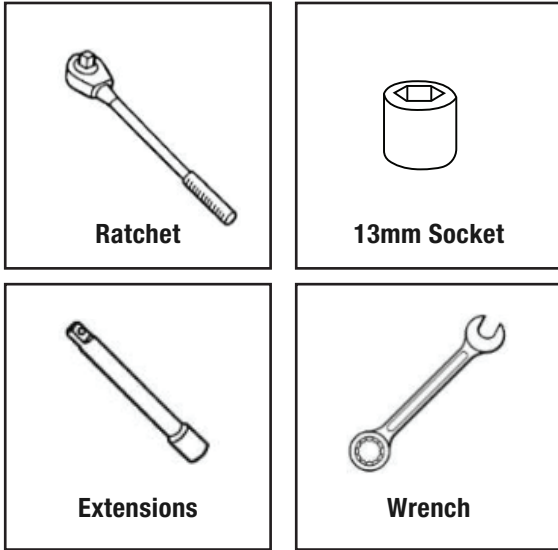

## STEP 1 MOUNTING BRACKETS

Follow (Fig 1 – 12) to attach the brackets to the Driver Side. Ensure hardware is hand tightened at this point.

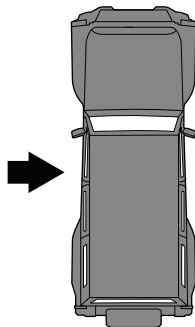

### Driver-side Front Mounting Area

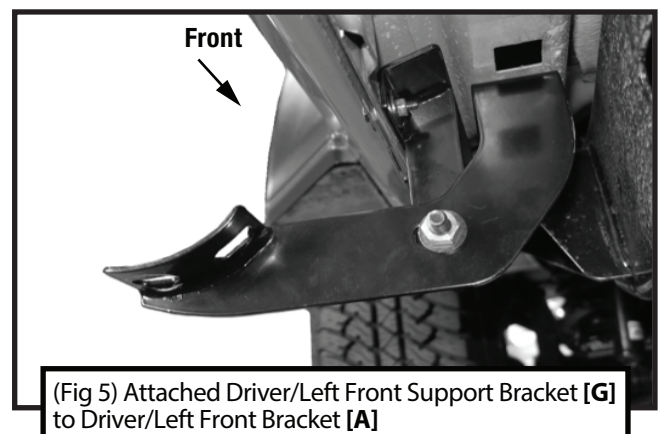
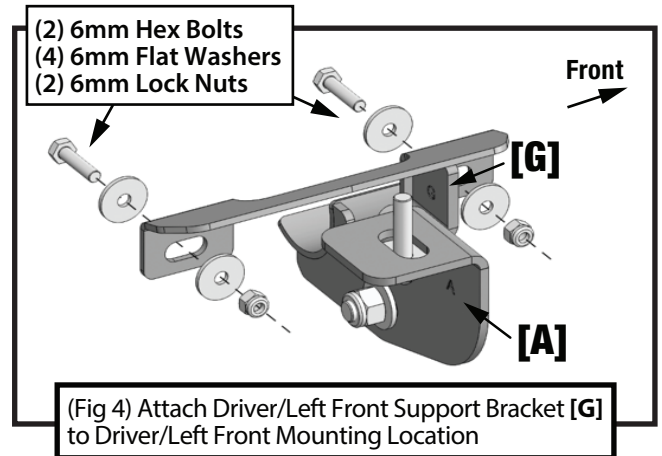
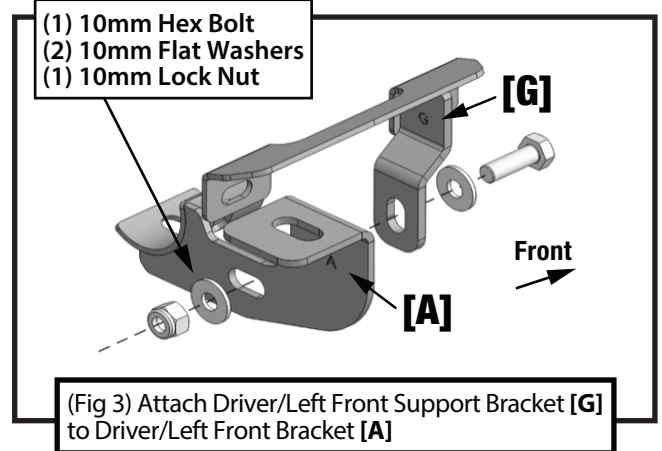
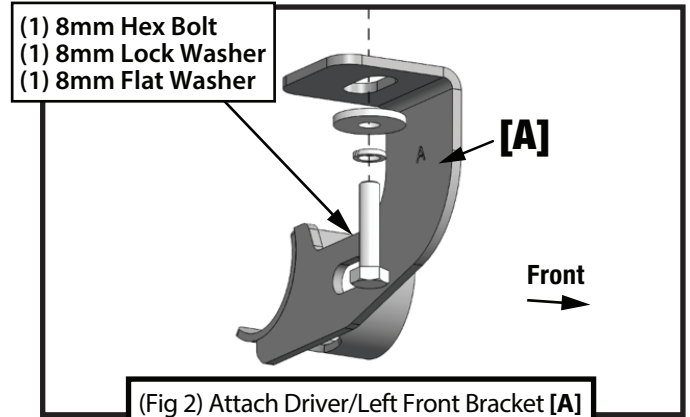
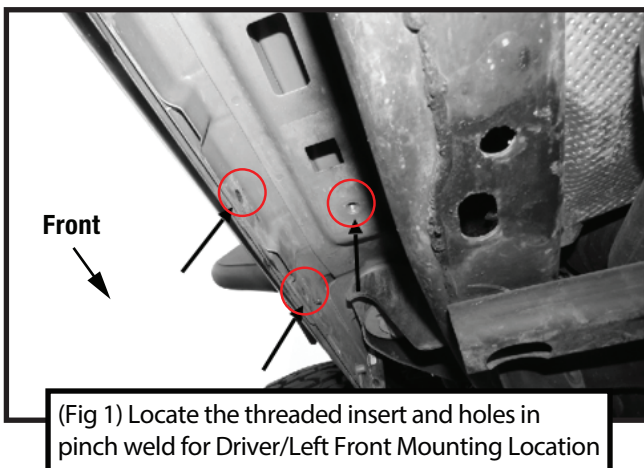

**Driver-side Center Mounting Area**

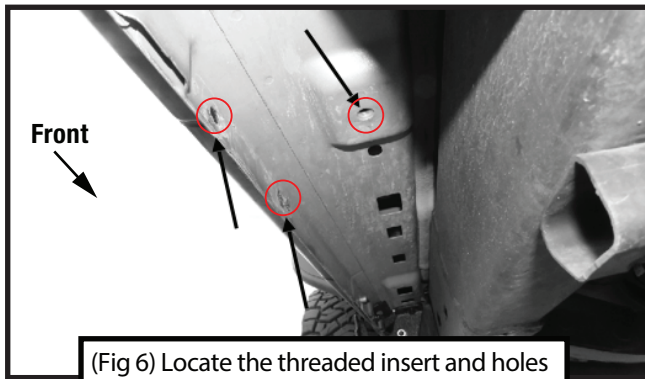

(Fig 6) Locate the threaded insert and holes in pinch weld for Center Mounting Location

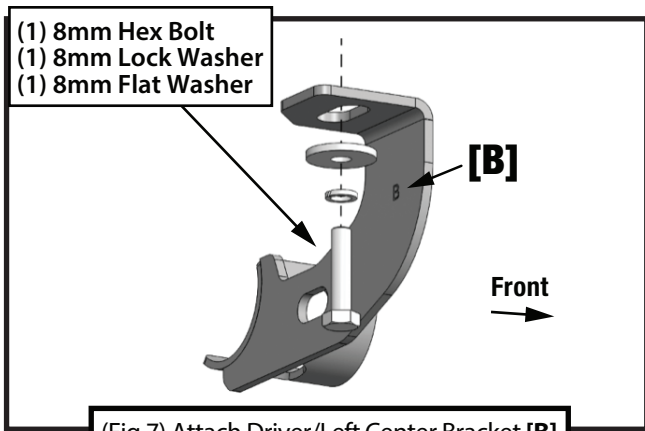

- (1) 8mm Hex Bolt
- (1) 8mm Lock Washer
- (1) 8mm Flat Washer

(Fig 7) Attach Driver/Left Center Bracket [B] to Driver/Left Center Mounting Location

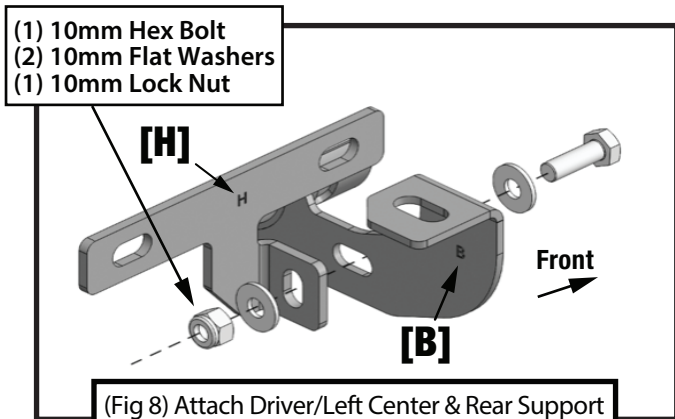

- (1) 10mm Hex Bolt
- (2) 10mm Flat Washers
- (1) 10mm Lock Nut

(Fig 8) Attach Driver/Left Center & Rear Support Bracket [H] to Driver/Left Center Bracket [B]

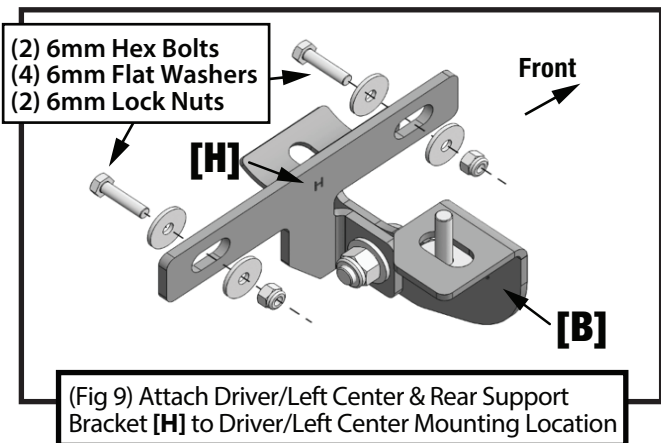

- (2) 6mm Hex Bolts
- (4) 6mm Flat Washers
- (2) 6mm Lock Nuts

(Fig 9) Attach Driver/Left Center & Rear Support Bracket [H] to Driver/Left Center Mounting Location

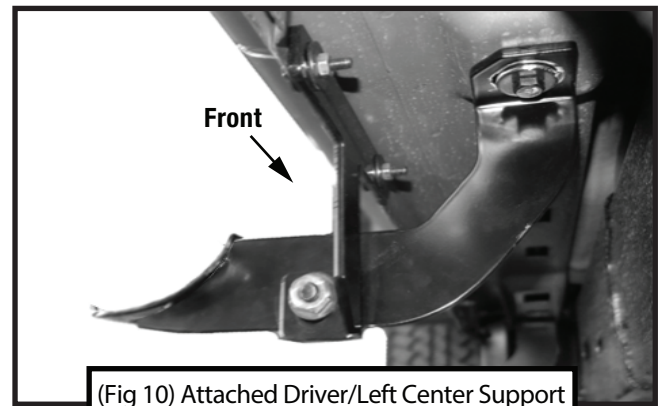

(Fig 10) Attached Driver/Left Center Support Bracket [H] to Driver/Left Center Bracket [B]

**Driver-side Rear Mounting Area**

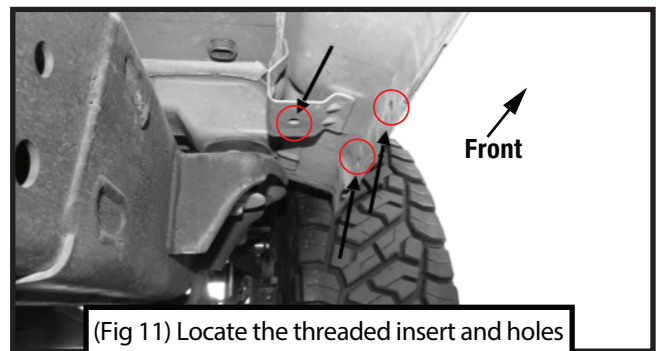

(Fig 11) Locate the threaded insert and holes in pinch weld for Rear Mounting Location

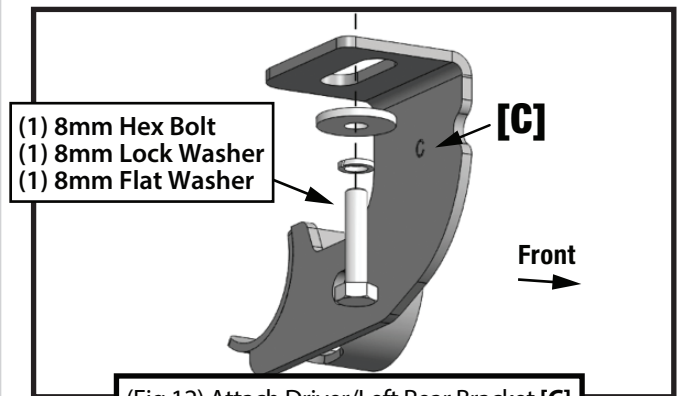

- (1) 8mm Hex Bolt
- (1) 8mm Lock Washer
- (1) 8mm Flat Washer

(Fig 12) Attach Driver/Left Rear Bracket [C] to Driver/Left Rear Mounting Location

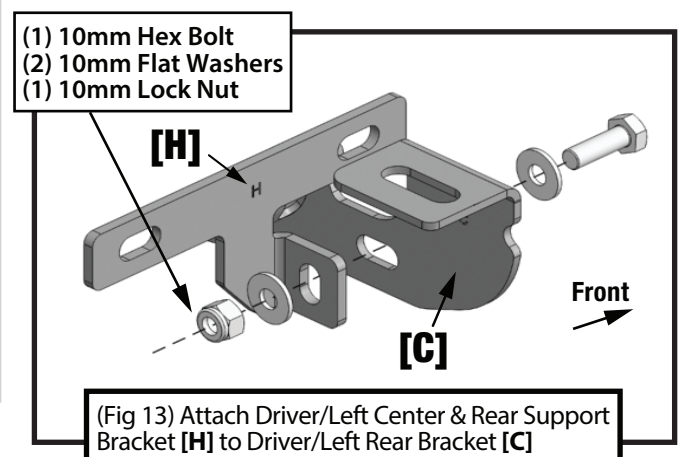

- (1) 10mm Hex Bolt
- (2) 10mm Flat Washers
- (1) 10mm Lock Nut

(Fig 13) Attach Driver/Left Center & Rear Support Bracket [H] to Driver/Left Rear Bracket [C]

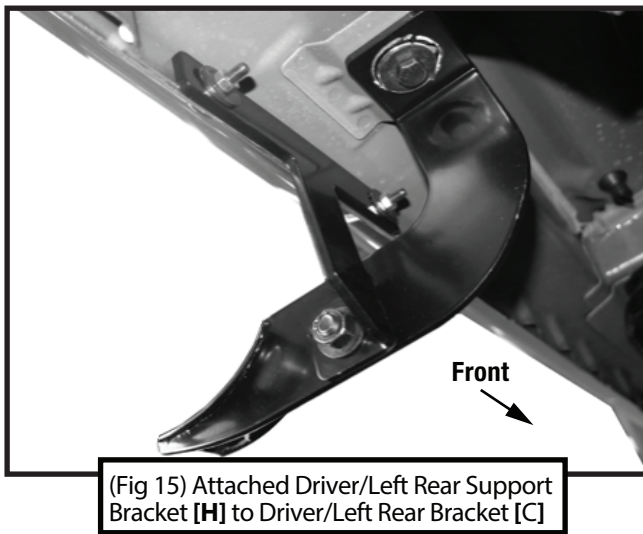
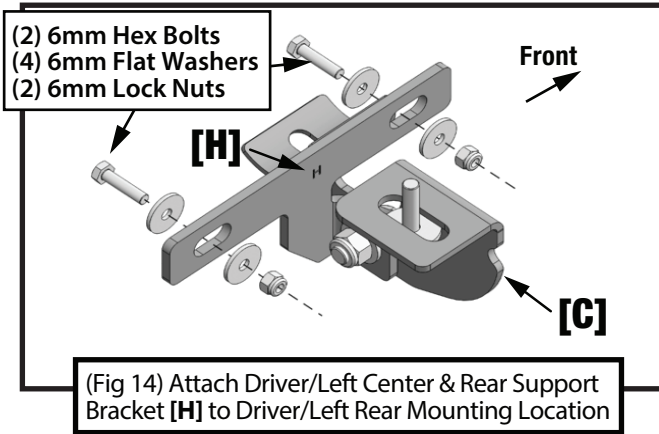

## STEP 2 MOUNTING RUNNING BOARD

Follow (Fig 13) to install the Kobra Drop Step on the Driver/Left Mounting Brackets. Ensure all hardware is hand tightened at this point.

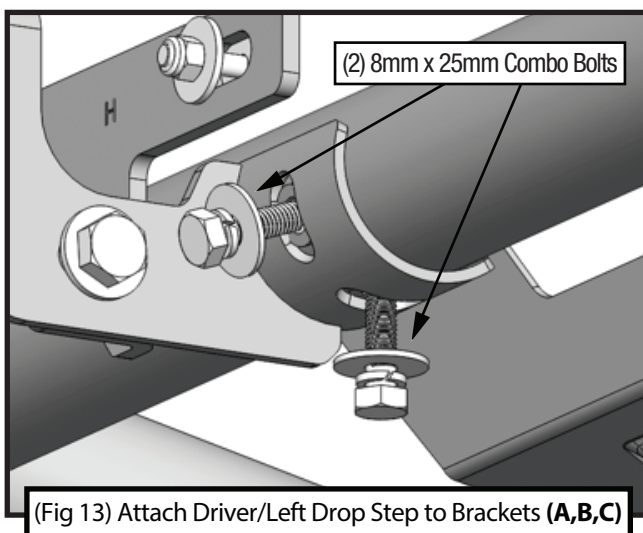

## STEP 3 PASSENGER SIDE

Repeat **STEPS 1-2** for passenger side installation. Use Front Mounting Bracket [D] instead of [A]; Use Front Support Bracket [I] instead of [G]; Use Center Mounting Bracket [E] instead of [B]; Use Rear Mounting Bracket [F] instead of [C]; Use Center & Rear Support Bracket [J] instead of [H].

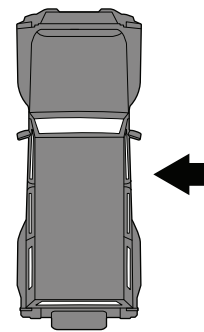

## STEP 4

Ensure Tyger Kobra Drop Step is level and straightened, then tighten all fasteners. Installation is complete. Perform periodic inspections to the installation to make sure that all hardware is secure and tight.

