



# TYGER KOBRA

TG-KB2T25005

Scan to Download the Latest Digital Version



## BEFORE INSTALLATION

READ INSTRUCTIONS CAREFULLY BEFORE STARTING INSTALLATION. REMOVE CONTENTS FROM BOX AND VERIFY ALL PARTS ARE PRESENT. FAILURE TO IDENTIFY DAMAGE BEFORE INSTALLATION COULD LEAD TO A REJECTION OF ANY CLAIM. IF MISSING PARTS OR ANY DAMAGE FOUND, PLEASE TAKE A PICTURE FOR THE CLAIM PURPOSE. TO FILE YOUR CLAIM, PLEASE VISIT: [WWW.TYGERAUTO.COM/CONTACT](http://WWW.TYGERAUTO.COM/CONTACT)

## TORQUE VALUES

| Fastener Size | Class 8.8 Torque (ft-lbs) | Class 10.9 Torque (ft-lbs) |
|---------------|---------------------------|----------------------------|
| 6mm           | 6-7                       | 6-7                        |
| 8mm           | 15-16                     | 22-23                      |
| 10mm          | 31-32                     | 44-45                      |
| 12mm          | 54-55                     | 78-79                      |
| 14mm          | 87-88                     | 125-126                    |

- x1** Driver/Left Tyger Kobra
- x1** Passenger/Right Tyger Kobra
- x1** Driver/Left Front Mounting Bracket [A]
- x1** Passenger/Right Front Mounting Bracket [D]
- x1** Driver/Left Center Mounting Bracket [B]
- x1** Passenger/Right Center Mounting Bracket [E]
- x1** Driver/Left Rear Mounting Bracket [C]
- x1** Passenger/Right Rear Mounting Bracket [F]
- x12** 8mm x 24mm x 2mm Flat Washers
- x12** 8mm Lock Washers
- x12** 8-1.25mm x 30mm Hex Bolts
- x12** 8mm x 1.25mm x 25mm Hex Combo Bolts

## Parts List

### Top View

**ATTENTION:** Refer to **D** and **P** labelling on the side of the tubes to determine Driver and Passenger TYGER Kobra

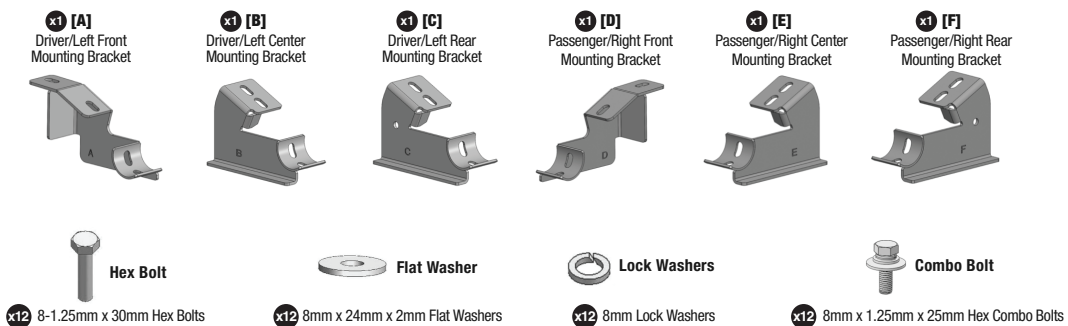
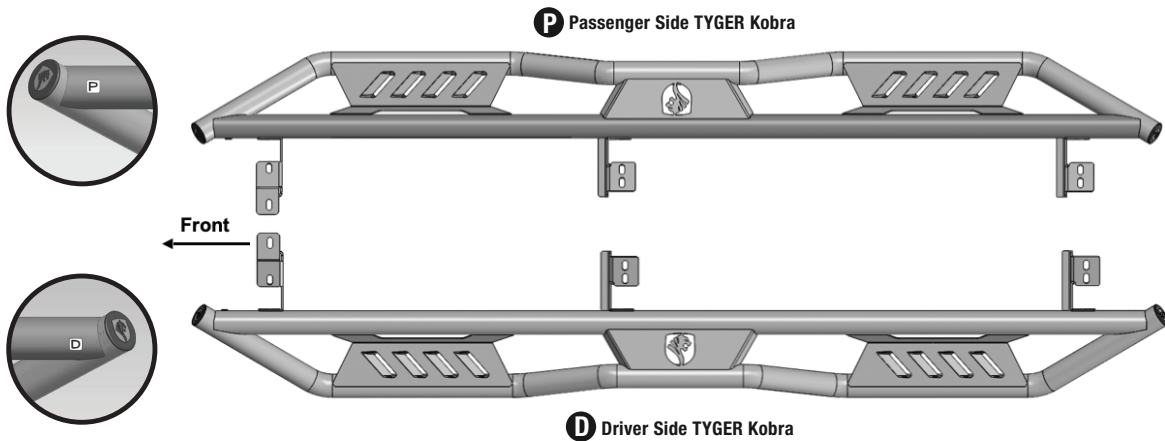

Reference the letters printed on the brackets to determine mounting locations

**Top View**

**D** Driver Side TYGER Kobra

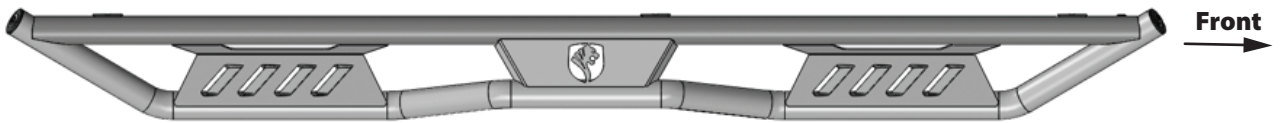
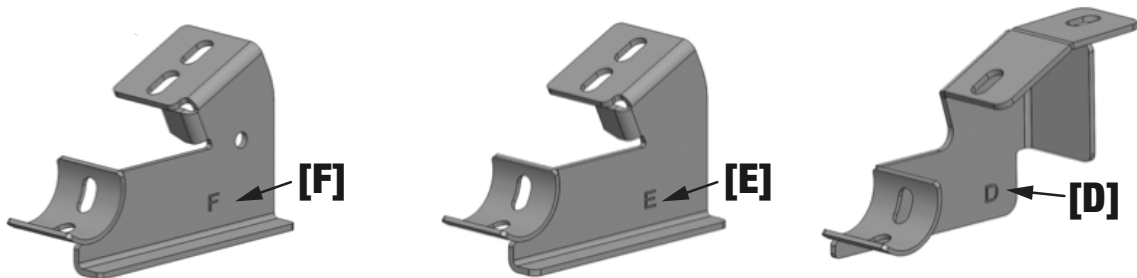
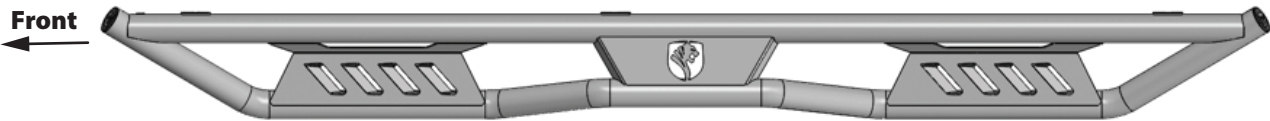
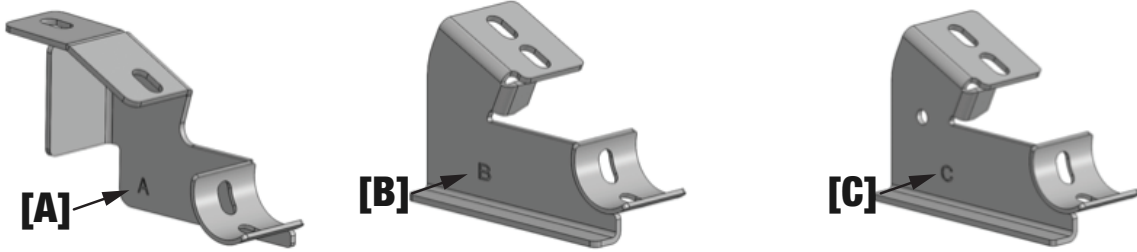

**P** Passenger Side TYGER Kobra

**Bottom View**

**D** Driver Side TYGER KOBRA

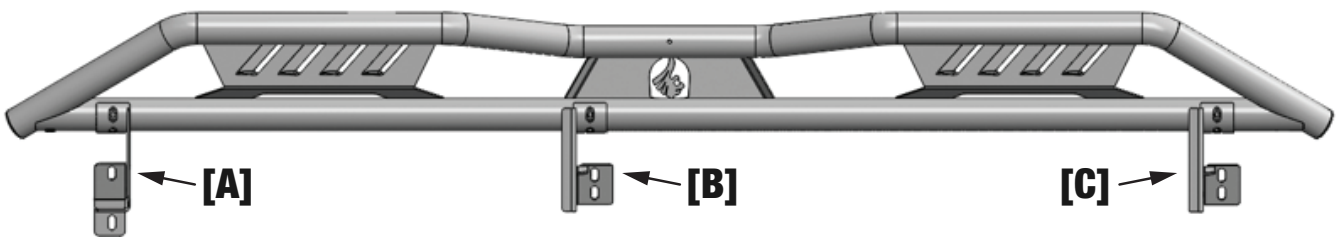

Front ←

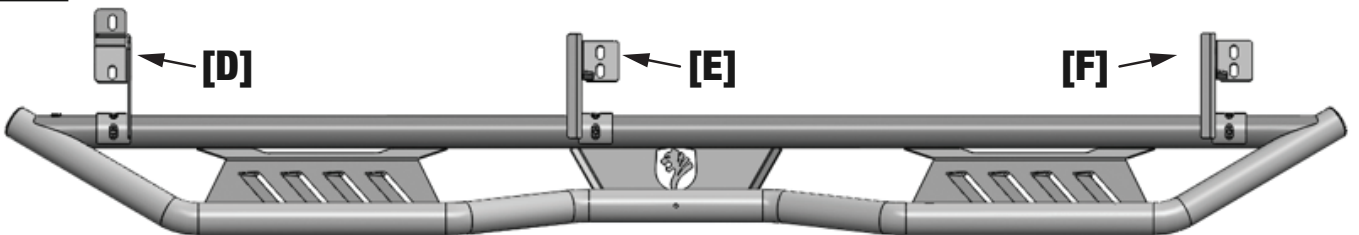

**P** Passenger Side TYGER KOBRA

## TOOLS REQUIRED

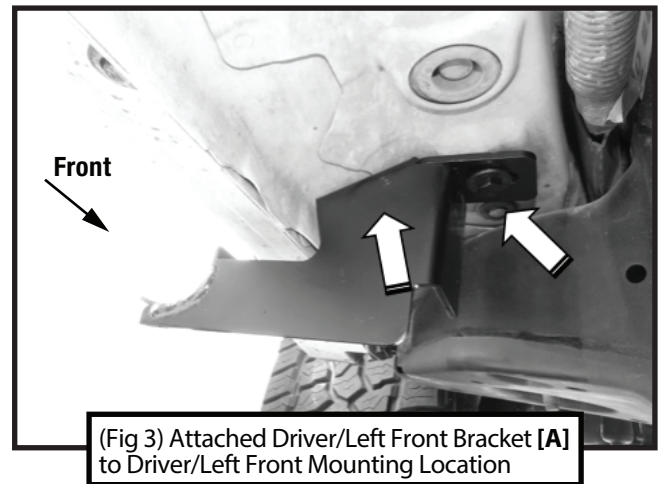
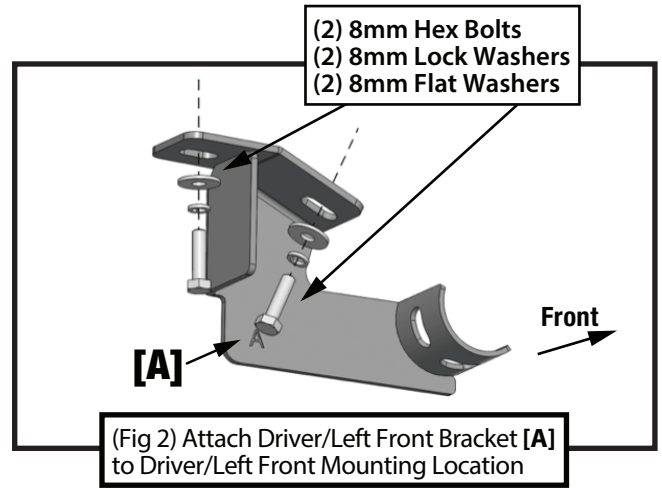
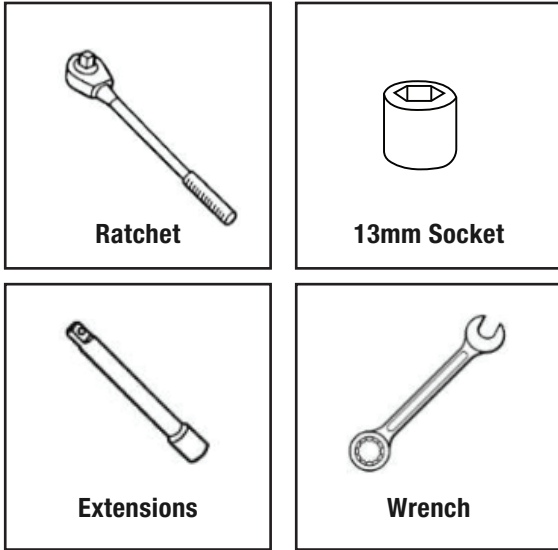

**Driver-side Center Mounting Area**

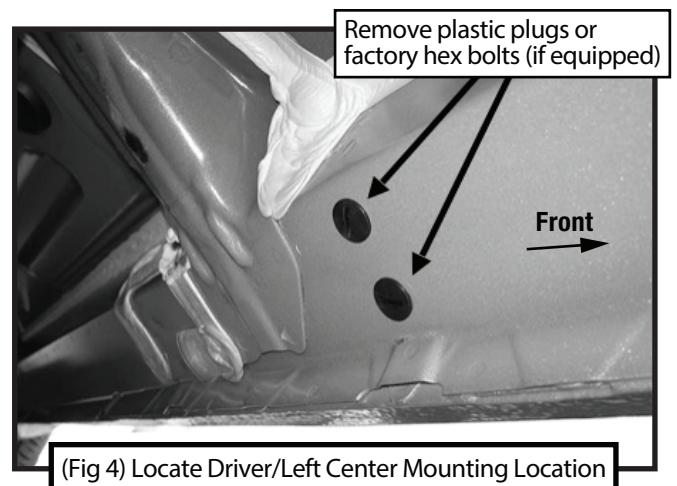

## STEP 1 MOUNTING BRACKETS

Follow (Fig 1 – 9) to attach the brackets to the Driver/Left Side. Ensure all hardware is hand tightened at this point.

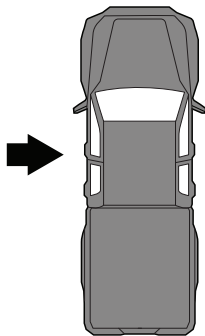

**Driver-side Front Mounting Area**

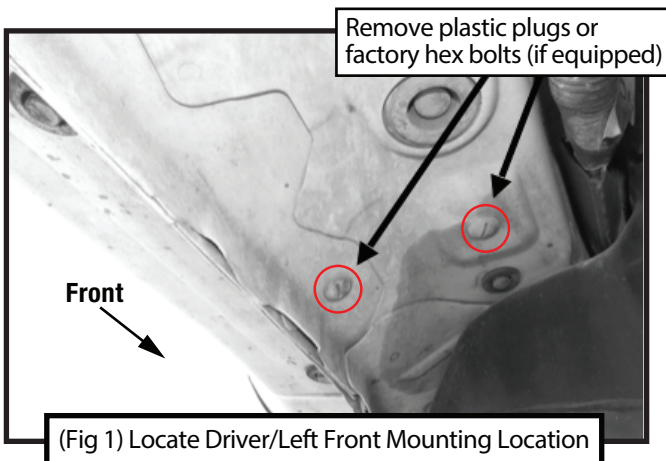

- (2) 8mm Hex Bolts
- (2) 8mm Lock Washers
- (2) 8mm Flat Washers

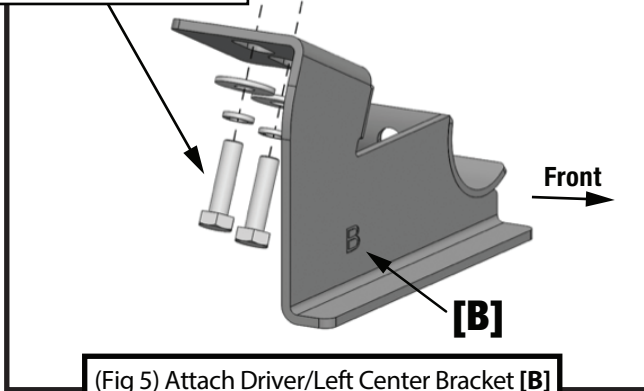

(Fig 5) Attach Driver/Left Center Bracket [B] to Driver/Left Center Mounting Location

- (2) 8mm Hex Bolts
- (2) 8mm Lock Washers
- (2) 8mm Flat Washers

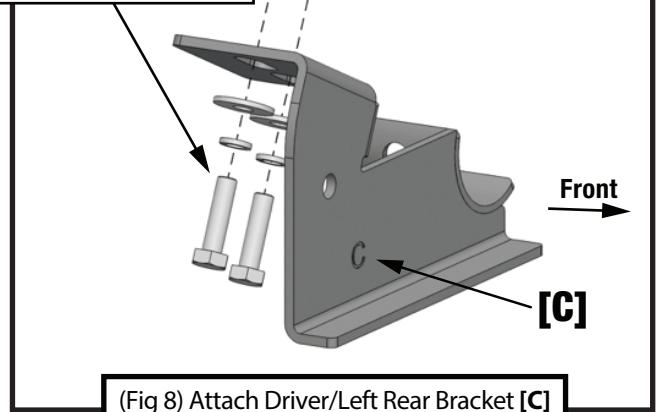

(Fig 8) Attach Driver/Left Rear Bracket [C] to Driver/Left Rear Mounting Location

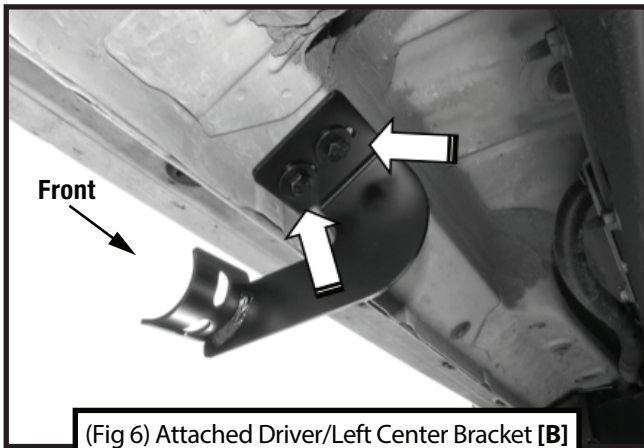

(Fig 6) Attached Driver/Left Center Bracket [B] to Driver/Left Center Mounting Location

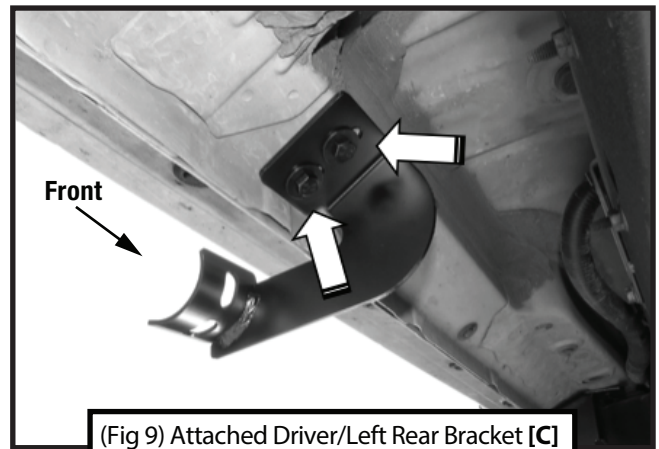

(Fig 9) Attached Driver/Left Rear Bracket [C] to Driver/Left Rear Mounting Location



**Driver-side Rear Mounting Area**

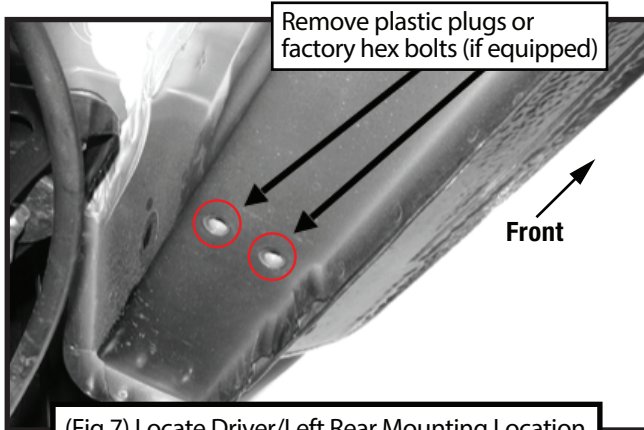

(Fig 7) Locate Driver/Left Rear Mounting Location

**STEP 2 MOUNTING RUNNING BOARD**

Follow (Fig 10 – 11) to install the Kobra Drop Step on the Driver/Left. Ensure all hardware is hand tightened at this point.

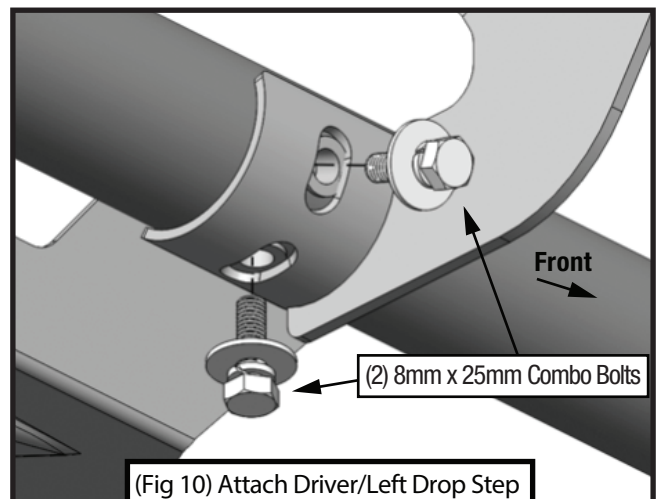

(Fig 10) Attach Driver/Left Drop Step to Driver/Left Brackets (A, B, C)



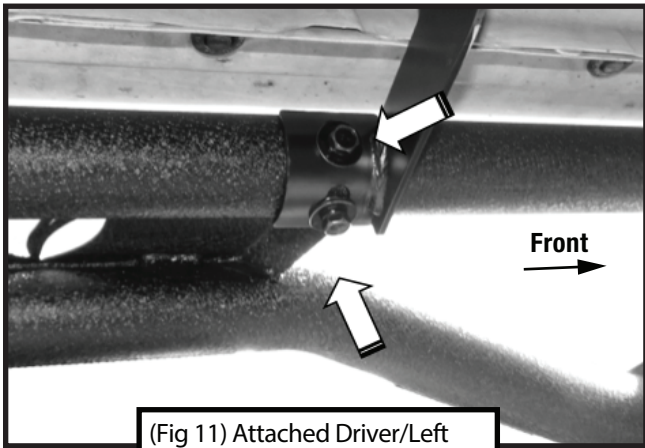

(Fig 11) Attached Driver/Left Drop Step to Driver/Left Bracket

### STEP 3 PASSENGER SIDE

Repeat **STEPS 1-2** for passenger side installation.  
 Use Front Mounting Bracket **[D]** instead of **[A]**;  
 Use Center Mounting Bracket **[E]** instead of **[B]**;  
 Use Rear Mounting Bracket **[F]** instead of **[C]**.

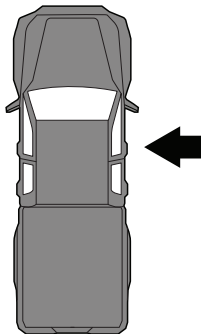

### STEP 4

Ensure Tyger Kobra Drop Step is level and straightened, then tighten all fasteners. Installation is complete. Perform periodic inspections to the installation to make sure that all hardware is secure and tight.

