



TYGER LanderX



TG-LX3C82458

BEFORE INSTALLATION

READ INSTRUCTIONS CAREFULLY BEFORE STARTING INSTALLATION. REMOVE CONTENTS FROM BOX AND VERIFY ALL PARTS ARE PRESENT. FAILURE TO IDENTIFY DAMAGE BEFORE INSTALLATION COULD LEAD TO A REJECTION OF ANY CLAIM. IF MISSING PARTS OR ANY DAMAGE FOUND, PLEASE TAKE A PICTURE FOR THE CLAIM PURPOSE. TO FILE YOUR CLAIM, PLEASE VISIT: WWW.TYGERAUTO.COM/CONTACT

TORQUE VALUES

Fastener Size	Class 8.8 Torque (ft-lbs)	Class 10.9 Torque (ft-lbs)
6mm	6-7	6-7
8mm	15-16	22-23
10mm	31-32	44-45
12mm	54-55	78-79
14mm	87-88	125-126

- x1** Driver/Left TYGER LanderX
- x4** Passenger/Right Mounting Brackets (B)
- x16** 8mm x 24mm x 2mm Flat Washers
- x1** Passenger/Right TYGER LanderX
- x16** 8-1.25mm x 25mm Combination Hex Bolts 
- x16** 8mm Lock Washers
- x4** Driver/Left Mounting Bracket (A)
- x16** 8-1.25mm x 30mm Hex Bolt 

Parts List

Reference the letters printed on the brackets to determine mounting locations

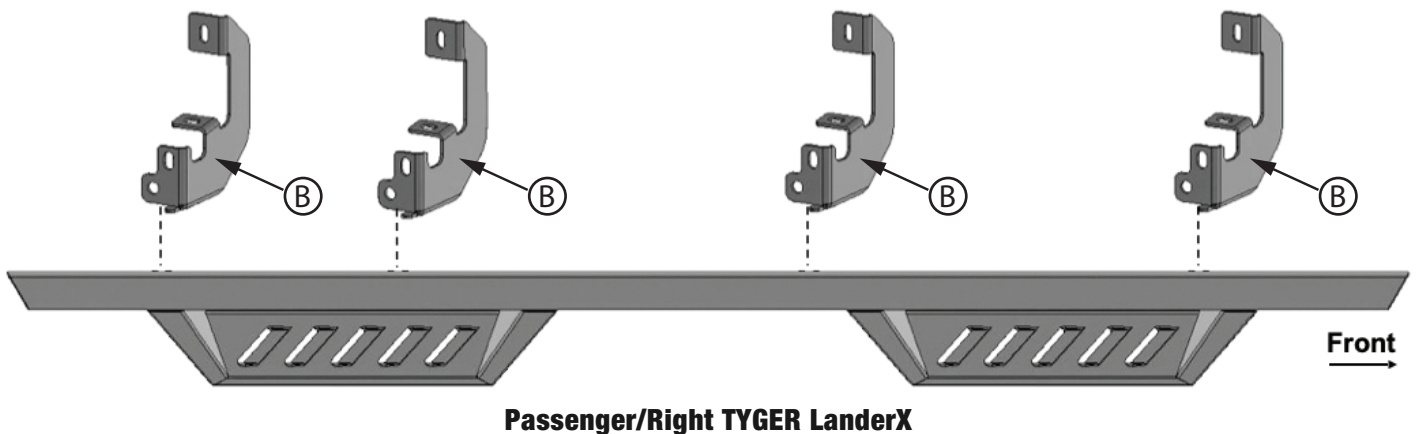
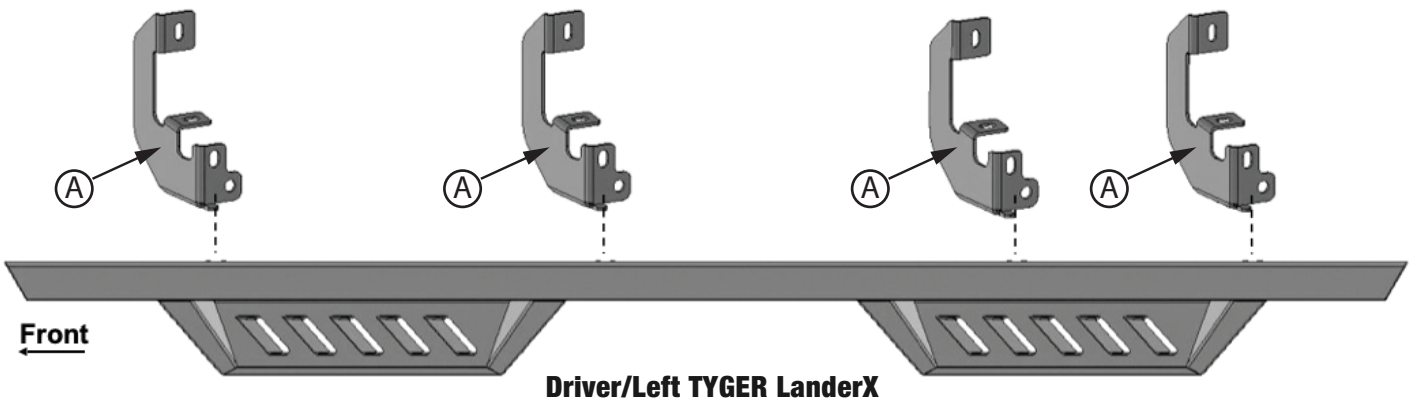

Bottom View

ATTENTION: Refer to the **D** or **P** labelling on the tubes to determine the Driver or Passenger side steps.

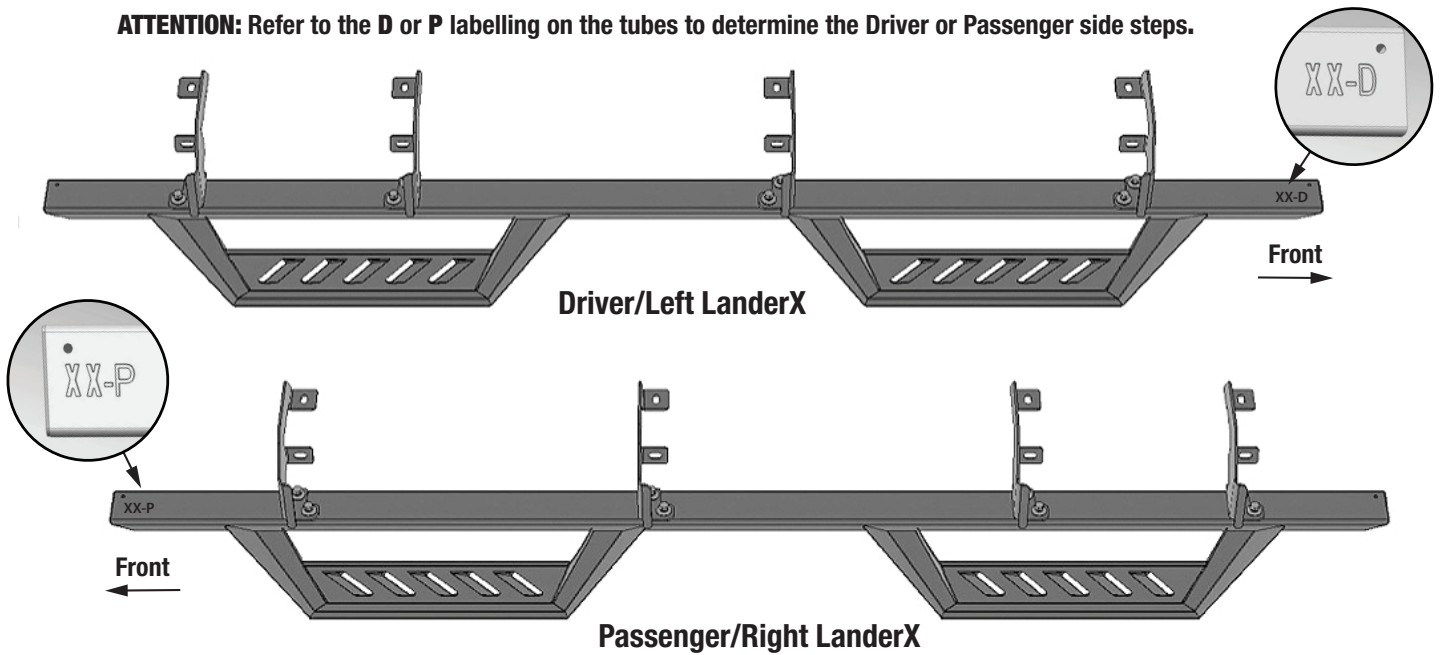

PROCEDURE:

REMOVE CONTENTS FROM BOX. VERIFY ALL PARTS ARE PRESENT. READ INSTRUCTIONS CAREFULLY BEFORE STARTING INSTALLATION. ASSISTANCE IS RECOMMENDED.

STEP 1

Start the installation under the driver/left side of the vehicle. Locate the plastic plug along the bottom edge of the body (Fig 1). Directly above each threaded hole is a top mounting location on the side of the body panel. Hold Mounting Bracket up in place to help determine the mounting holes to use along the body.

NOTE: Remove excess sealant or paint from area around threads. Thread an 8mm Hex Bolt into the threaded inserts to clear paint from threads as necessary.

Driver/Left side Installation Pictured

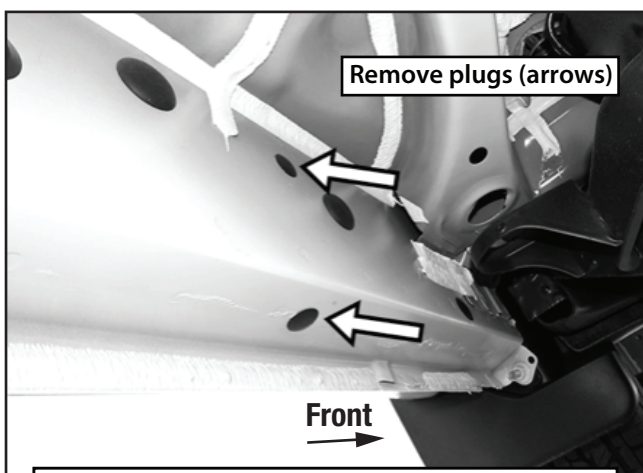

(Fig 1) Remove plastic plugs to uncover threaded inserts. Driver/left front location pictured

STEP 2

Select (1) Driver/Left Side Mounting Bracket **(A)** (Fig 2). Attach the Bracket to the (2) threaded holes with the included (2) 8mm x 30mm Hex Bolts, (2) 8mm Lock Washers and (2) 8mm Flat Washers (Figs 2 & 3). **DO NOT** fully tighten hardware.

Driver/Left side Installation Pictured

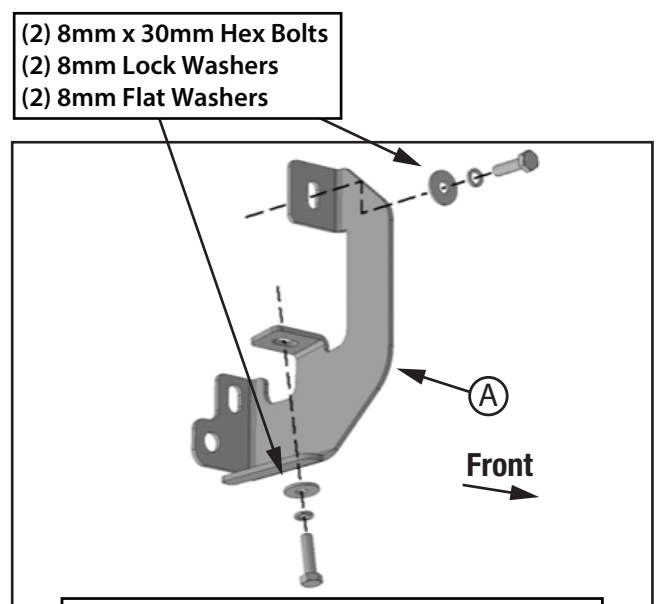

(Fig 2) Attach the Driver/Left Mounting Brackets **(A) to the threaded holes in the floor**

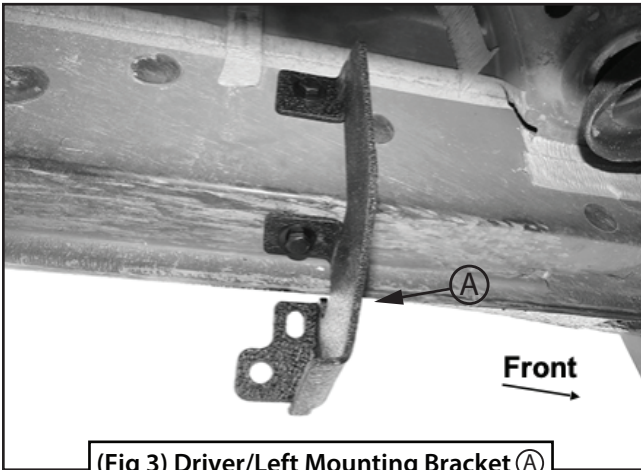

(Fig 3) Driver/Left Mounting Bracket (A) installed in front mounting location

STEP 3

Move to the second mounting location next along the body panel (Fig 4). Repeat **STEPS 1 & 2** to attach (1) Driver/Left Side Mounting Bracket (A) to the second mounting location (Fig 5).

Driver/Left side Installation Pictured

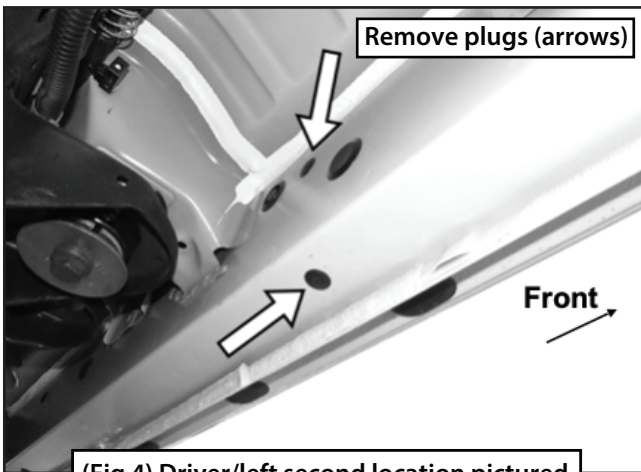

(Fig 4) Driver/left second location pictured

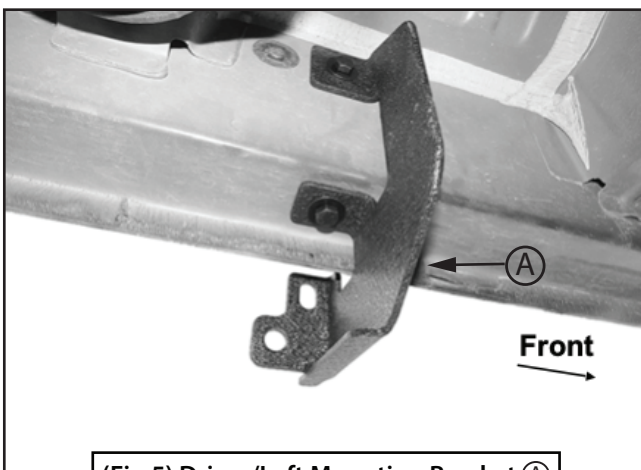

(Fig 5) Driver/Left Mounting Bracket (A) installed in second mounting location

STEP 4

Continue to the third mounting location next along the body panel (Fig 6). Repeat **STEPS 1 & 2** to attach (1) Driver/Left Side Mounting Bracket (A) to the third mounting location (Fig 7).

Driver/Left side Installation Pictured

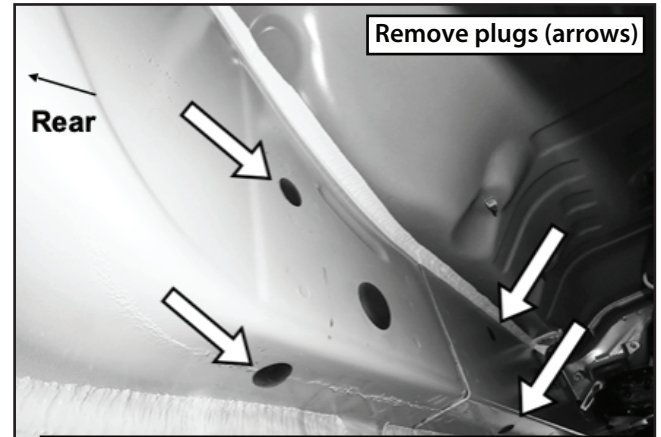

(Fig 6) Driver/left third and rear locations pictured

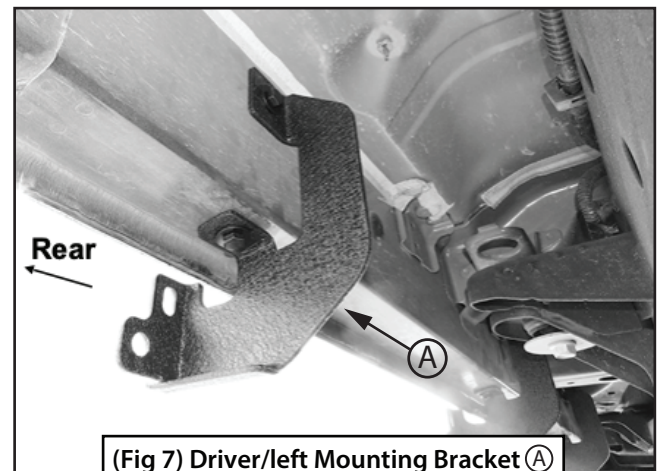

(Fig 7) Driver/left Mounting Bracket (A) installed in third mounting location

STEP 5

Finally, locate the rear mounting location at the back of the cab (Fig 6). Repeat **STEPS 1 & 2** to attach the remaining Driver/Left Side Mounting Bracket (A) to the last mounting location (Fig 8).

Driver/Left side Installation Pictured

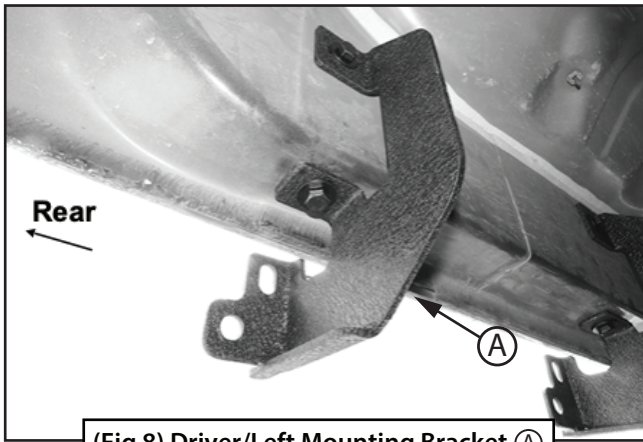

(Fig 8) Driver/Left Mounting Bracket (A) installed in rear mounting location

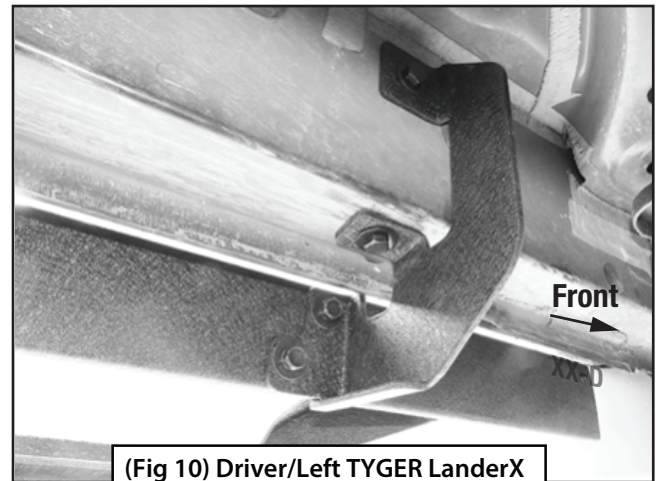

(Fig 10) Driver/Left TYGER LanderX attached to front Mounting Bracket

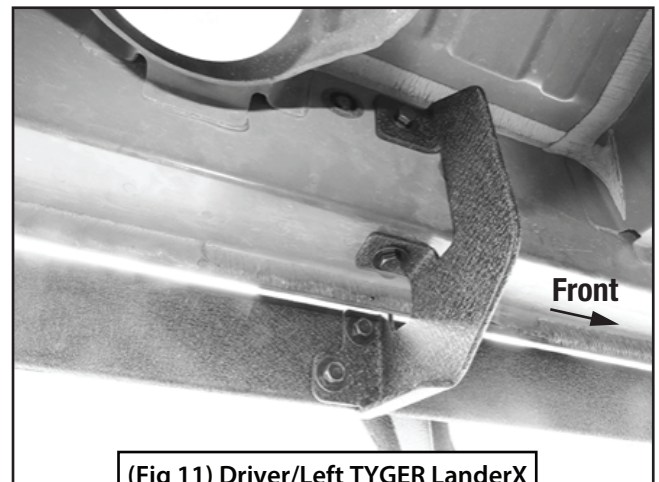

(Fig 11) Driver/Left TYGER LanderX attached to Second Bracket

STEP 6

Carefully unwrap the TYGER LanderX. Select the Driver/Left TYGER LanderX. Note “D” on back of tube. Carefully position the TYGER LanderX up to the (4) Brackets. **IMPORTANT:** DO NOT slide, (front to back or rotate), the TYGER LanderX against the Brackets or damage to the finish may result. Attach the TYGER LanderX to the Brackets with (8) 8mm x 25mm Combo Hex Bolt assemblies (Fig 9-14). DO NOT fully tighten hardware.

Driver/Left side Installation Pictured

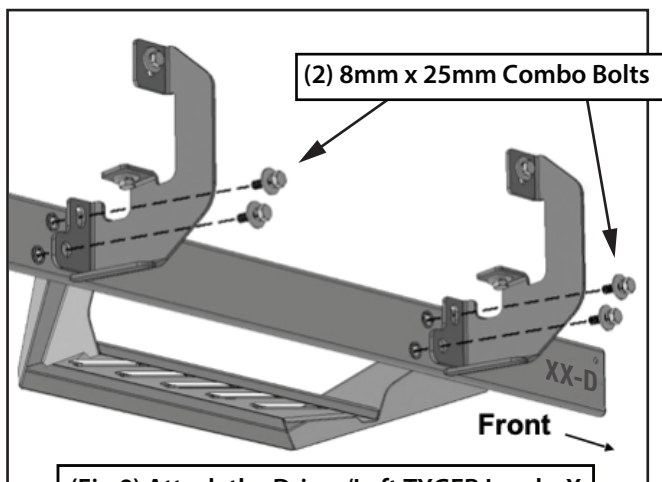

(Fig 9) Attach the Driver/Left TYGER LanderX to the Front and Second Mounting Brackets

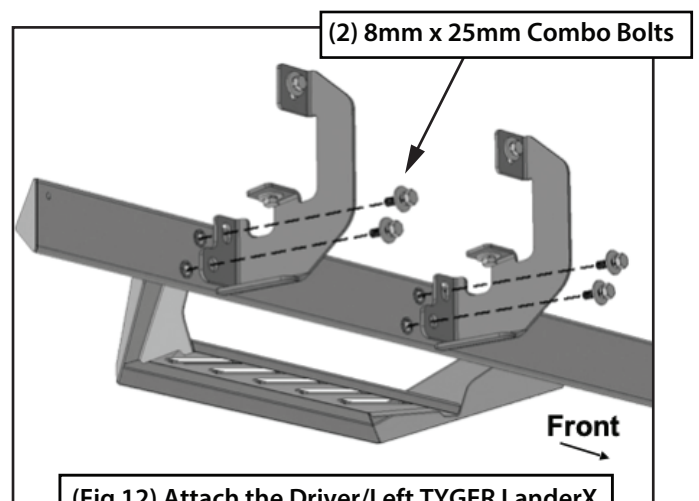

(Fig 12) Attach the Driver/Left TYGER LanderX to the Third and Rear Mounting Brackets



(Fig 13) Driver/Left TYGER LanderX attached to Third Mounting Bracket

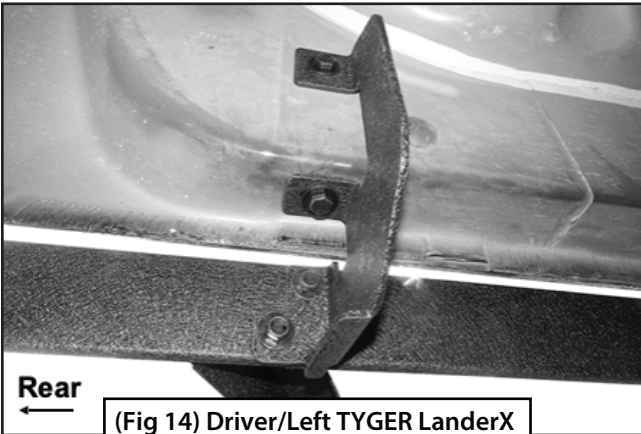

(Fig 14) Driver/Left TYGER LanderX attached to rear Mounting Bracket

STEP 8

Repeat **STEPS 1-7** for Passenger/Right TYGER LanderX installation.

STEP 9

Do periodic inspections to the installation to make sure that all hardware is secure and tight.

STEP 7

Level and adjust the TYGER LanderX and tighten all hardware.

Driver/Left side Installation Pictured

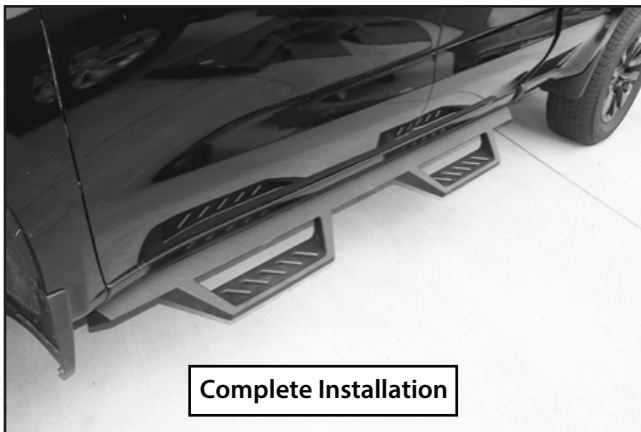

Complete Installation