



## SPORT BAR

TG-SB7C88518

### BEFORE INSTALLATION

READ INSTRUCTIONS CAREFULLY BEFORE STARTING INSTALLATION. REMOVE CONTENTS FROM BOX AND VERIFY ALL PARTS ARE PRESENT. FAILURE TO IDENTIFY DAMAGE BEFORE INSTALLATION COULD LEAD TO A REJECTION OF ANY CLAIM. IF MISSING PARTS OR ANY DAMAGE FOUND, PLEASE TAKE A PICTURE FOR THE CLAIM PURPOSE. TO FILE YOUR CLAIM, PLEASE VISIT: [WWW.TYGERAUTO.COM/CONTACT](http://WWW.TYGERAUTO.COM/CONTACT)

### DISCLAIMER

THIS PRODUCT IS NOT DESIGNED TO WORK AS A SAFETY DEVICE AGAINST ROLLOVER ACCIDENTS. TYGER AUTO IS NOT RESPONSIBLE OR LIABLE FOR ANY DAMAGES & INJURIES AS A RESULT OF A ROLLOVER ACCIDENTS.

### TORQUE VALUES

Fastener Size	Class 8.8 Torque (ft-lbs)	Class 10.9 Torque (ft-lbs)
6mm	6-7	6-7
8mm	15-16	22-23
10mm	31-32	44-45
12mm	54-55	78-79
14mm	87-88	125-126

## Parts List

- x1 Front Cross Tube
- x1 Driver/Left Cross Tube
- x1 Passenger/Right Cross Tube
- x1 Driver/Left Base Bracket
- x1 Passenger/Right Base Bracket
- x1 Driver/Left Decorative Plate
- x1 Passenger/Right Decorative Plate
- x1 Driver/Left Logo Plate
- x1 Passenger/Right Logo Plate
- x2 L-Brackets
- x1 Driver/Left Plastic Sleeve
- x1 Passenger/Right Plastic Sleeve
- x4 Plastic Base Covers
- x2 Rubber Plugs
- x4 12-1.75mm x 35mm Flat Head Bolt
- x2 12-1.5mm x 60mm Button Head Bolts
- x2 12mm Lock Washers
- x2 12mm x 24mm OD x 2.5mm Flat Washers
- x6 8-1.25mm x 40mm Hex Bolts
- x2 8-1.25mm x 25mm Hex Bolts
- x2 8-1.25mm x 16mm Hex Bolts
- x12 8mm x 24mm OD x 2mm Flat Washers
- x10 8mm Lock Washers
- x2 8mm Hex Nuts
- x6 8mm Nut Plates
- x2 6-1.0mm x 20mm Button Head Combo Bolts
- x8 6mm Flange Nuts
- x1 8mm Hex Wrench
- x1 4mm Hex Wrench
- x1 12mm Fish Wire

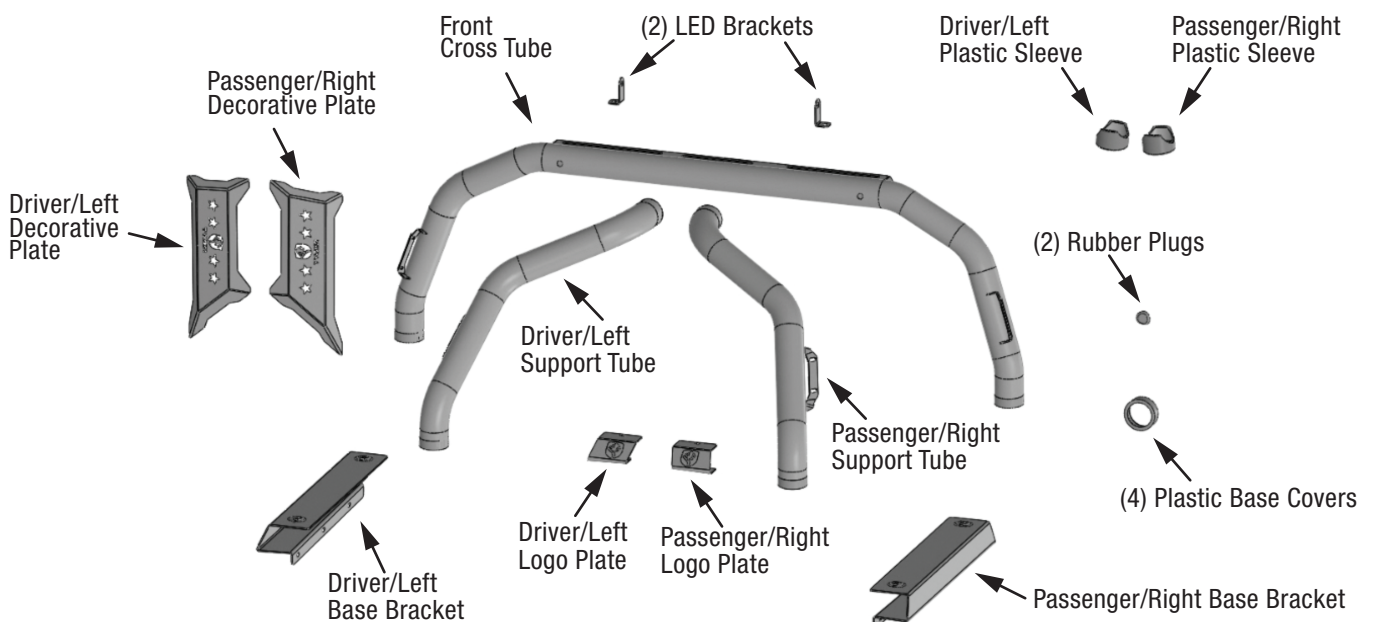



## PROCEDURE:

REMOVE CONTENTS FROM BOX. VERIFY ALL PARTS ARE PRESENT. READ INSTRUCTIONS CAREFULLY BEFORE STARTING INSTALLATION. ASSISTANCE IS RECOMMENDED. DRILLING IS REQUIRED. CUTTING OF PLASTIC BED LINER (IF EQUIPPED) MAY BE REQUIRED.

## STEP 1

Select the Front Cross Tube. Insert (1) 12mm Button Head Bolt into (1) 12mm Lock Washer and (1) 12mm Flat Washer. Thread the bolt assembly into the 12mm Fish Wire, (Fig 1). Slide the Fish Wire assembly through the holes in the Front Cross Tube, (Figs 2 & 3). Insert 8mm Hex Wrench into the head of the bolt to hold it in place inside the tube, (Fig 4).

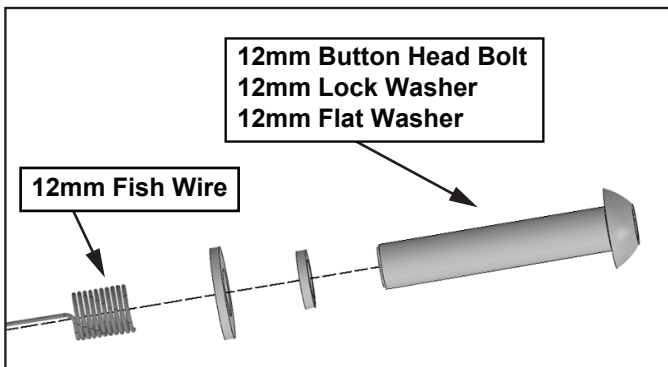

(Fig 1) Thread 12mm assembly into the 12mm Fish Wire

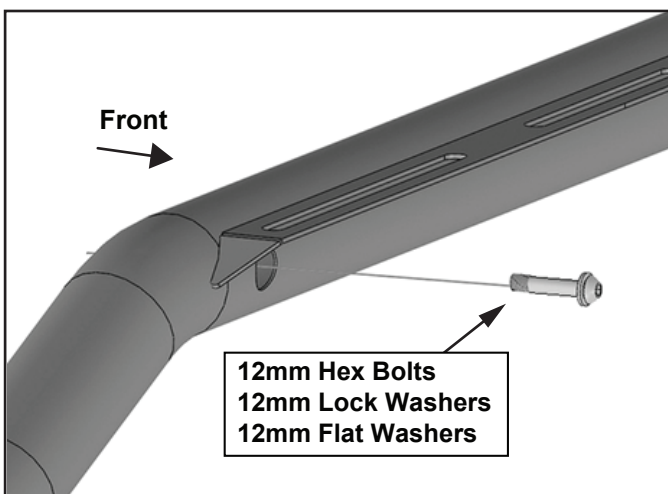

(Fig 2) Use Fish wire to pull 12mm Hex Bolt into the Front Cross Tube

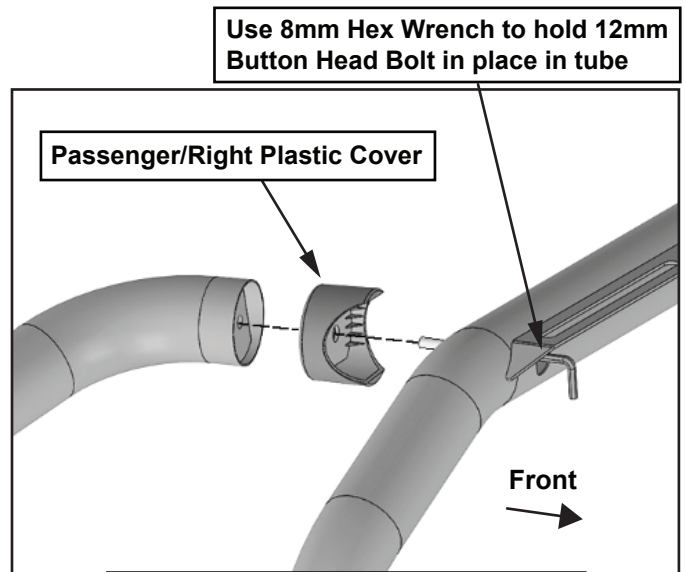
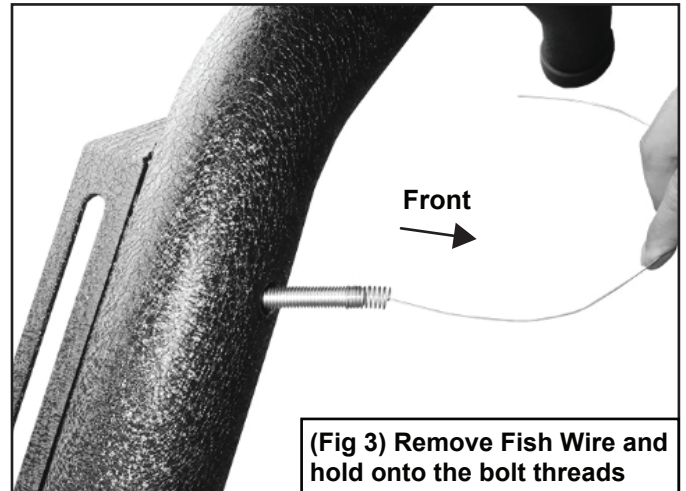

(Fig 4) Passenger/Right Support Tube installation to Front Cross Tube

## STEP 2

Slide the Passenger/ Right Plastic Sleeve onto the Passenger/Right Rear Support Tube. Thread the 12mm Button Head Bolt into the Passenger/Right Support Tube, (Figs 4 & 5).

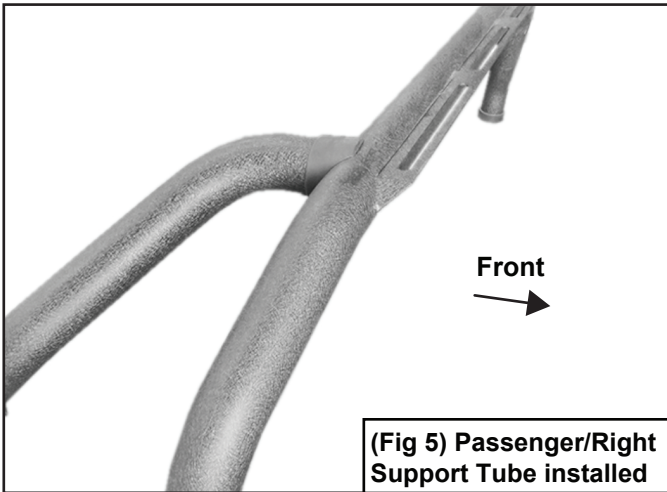

(Fig 5) Passenger/Right Support Tube installed

## STEP 3

Repeat **STEPS 1 & 2** to attach the Driver/Left Rear Support Tube. **DO NOT** tighten hardware at this time.

## STEP 4

Slide (2) Plastic Base Covers onto the bottom of the Passenger/Right tubes. Select the Passenger/Right Base Bracket. Attach the Base Bracket to the bottom of the Tubes with (2) 12mm Flat Head Bolts, (Fig 6). **DO NOT** tighten hardware at this time. Repeat this Step to attach the Driver/Left Base Bracket.

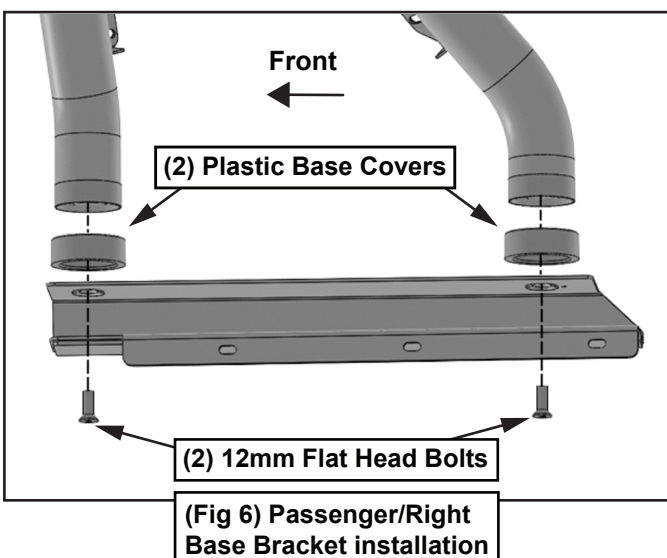

## STEP 5

Select the Passenger/Right Decorative Plate. Attach the Decorative Plate to the welded brackets on the sides of the Tubes with (4) 6mm Flange Nuts, (Figs 7 & 8). Repeat this **STEP** to attach the Driver/Left Decorative Plate. **DO NOT** tighten hardware at this time.

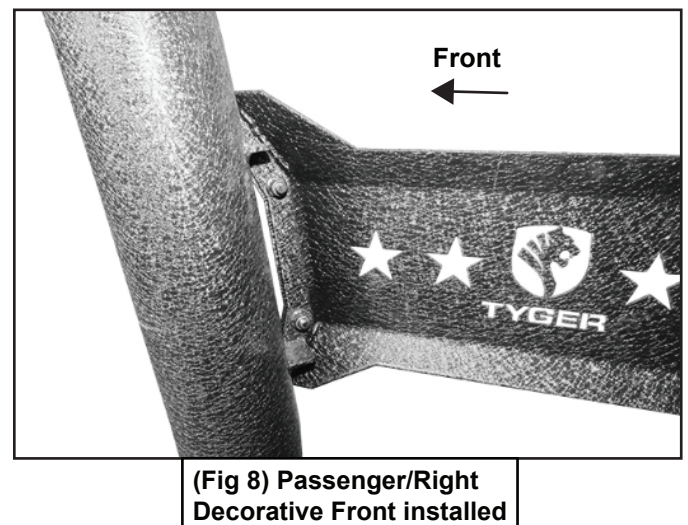
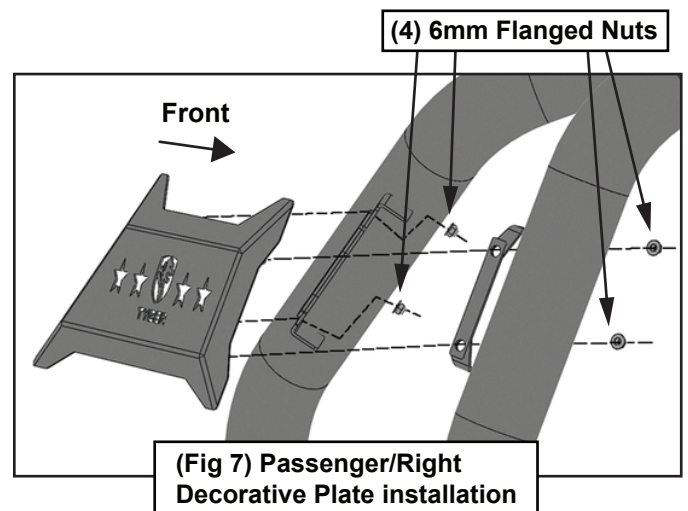



## STEP 6

With assistance, place the Sports Bar assembly onto the desired position on the bed of the vehicle. The Front Cross Tube should be at least 30mm away from the rear of the cab. Mark the holes in the Base Brackets to determine locations to drill holes in the lip of the bed, (Figs 9—11). Temporarily remove the Sports Bar. Using a 5/16" drill bit, drill holes for mounting. **IMPORTANT:** DO NOT drill too close to the edge of the bed or at the location of the plastic tabs under the lip of the bed, (Fig 10). Repeat this **STEP** for the Driver/Left side. Apply paint to the exposed metal to prevent rust.

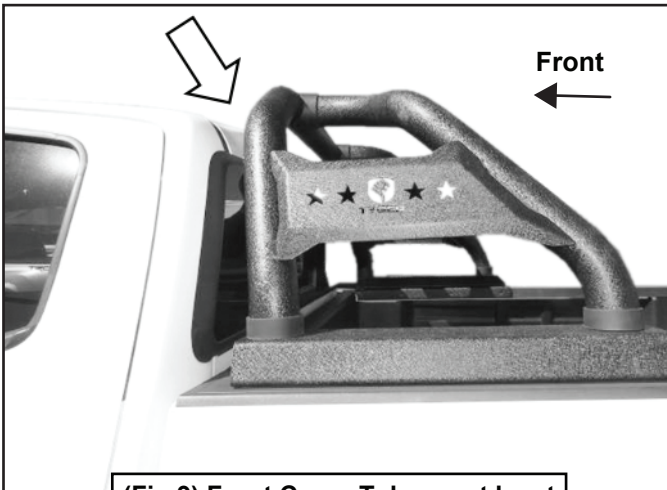

(Fig 9) Front Cross Tube must be at least 30mm from the rear of the cab

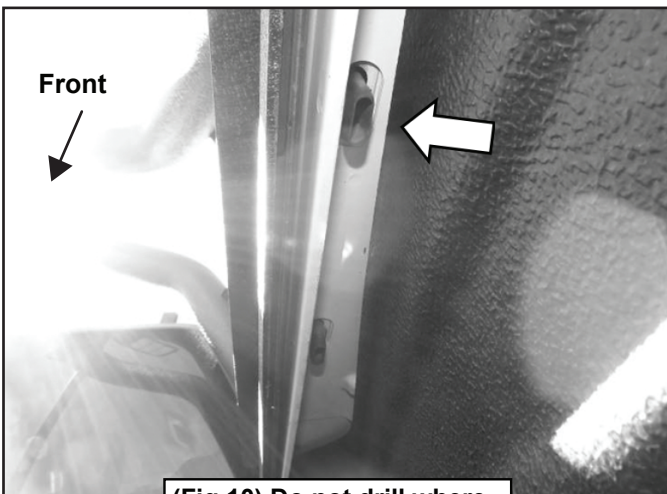

(Fig 10) Do not drill where the plastic tabs are located

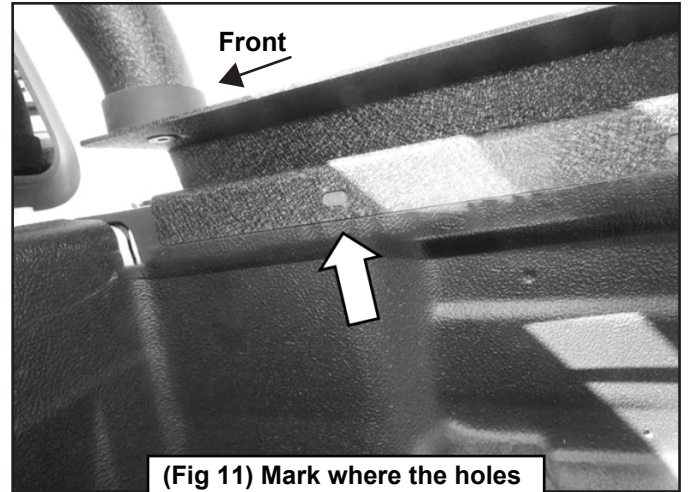

(Fig 11) Mark where the holes are on the top of the bed walls. Drill with a 5/16" drill bit

## STEP 7

Attach Sports Bar to the bed with (6) 8mm x 40mm Hex Bolts, (6) 8mm Lock Washers, (6) 8mm Flat Washers and (6) 8mm Nut Plates (Behind the top of the bed), (Fig 12). Tighten all hardware.

- (3) 8mm x 40mm Hex Bolts
- (3) 8mm Lock Washers
- (3) 8mm Flat Washers
- (3) 8mm Nut Plates

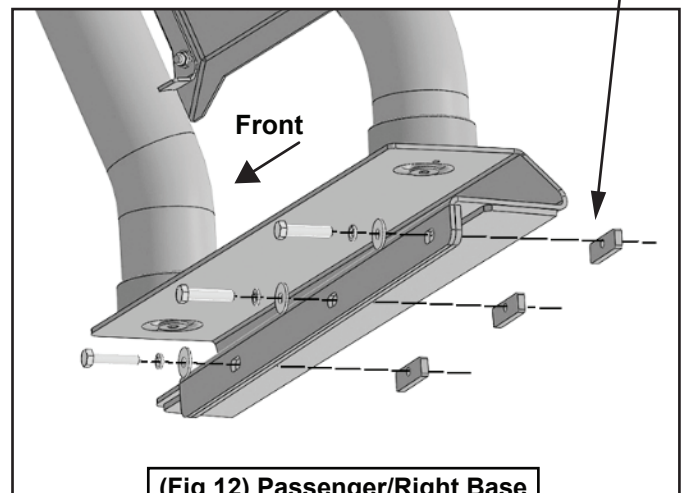

(Fig 12) Passenger/Right Base Bracket to bed installation



## STEP 8

Select (2) Rubber Plugs. Insert Plugs into the front holes of the Front Cross Tube, (Fig 13).

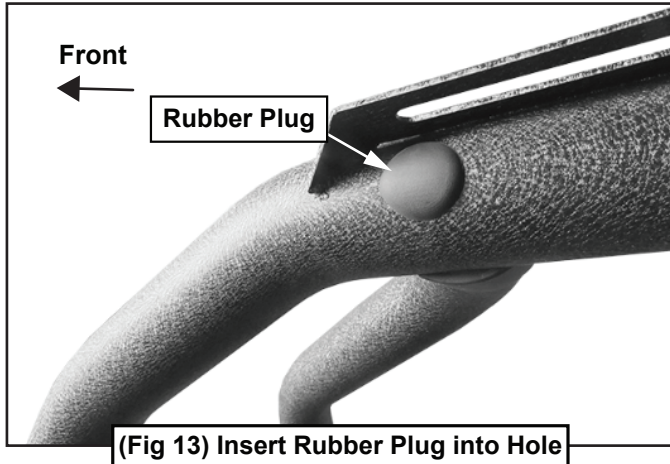

## STEP 9

**(Optional to attach a Light Bar)** Select (1) L-Bracket. Attach to the Passenger/Right top of the Sports Bar with (1) 8mm x 25mm Hex Bolt, (2) 8mm Flat Washers, (1) 8mm Lock Washer and (1) 8mm Hex Nut, (Fig 14). Repeat this **STEP** to attach (1) L-Bracket to the Driver/Left side.

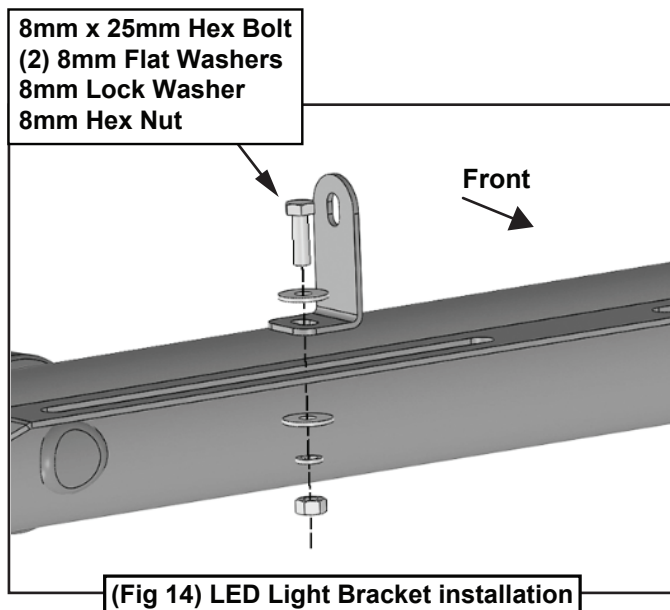

## STEP 10

Attach LED Light Bar (sold separately) to the L-Brackets with (2) 8mm x 16mm Hex Bolt, (2) 8mm Lock Washer and (2) 8mm Flat Washer, (Fig 15).

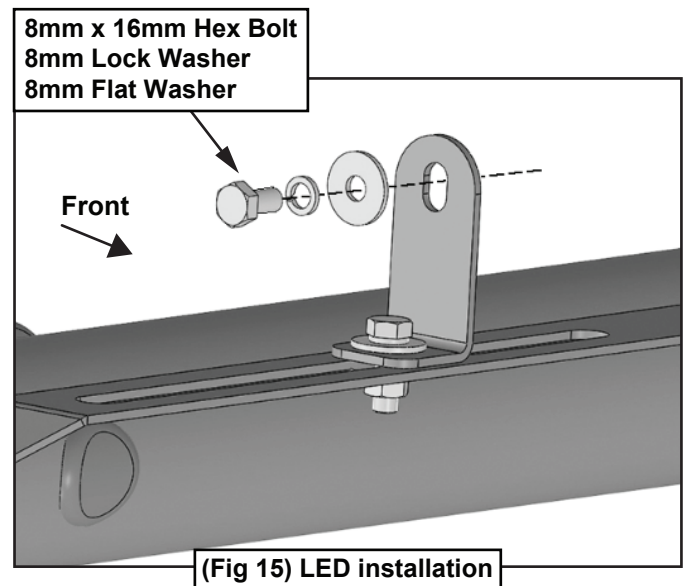

## STEP 11

**(OPTIONAL)** Locate the threaded mounting hole on the inside of the Base Bracket for the Passenger/Right Logo Plate. Attach Logo Plate with one 6mm Combo Bolt, (Figs 16—18). Repeat this **STEP** to attach the Driver/Left Logo Plate. **DO NOT** attach Plates if a tonneau cover will be installed.

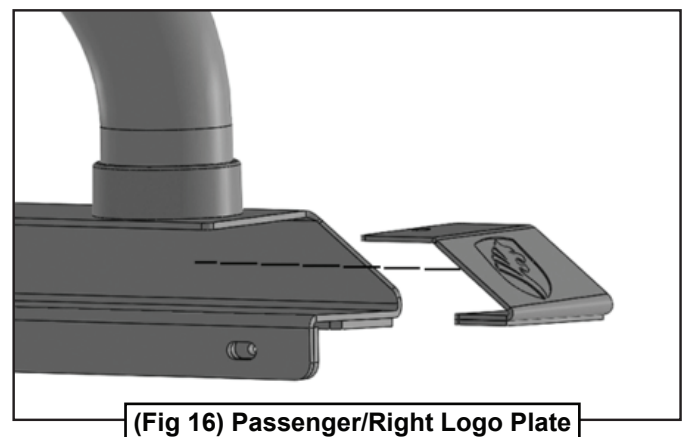

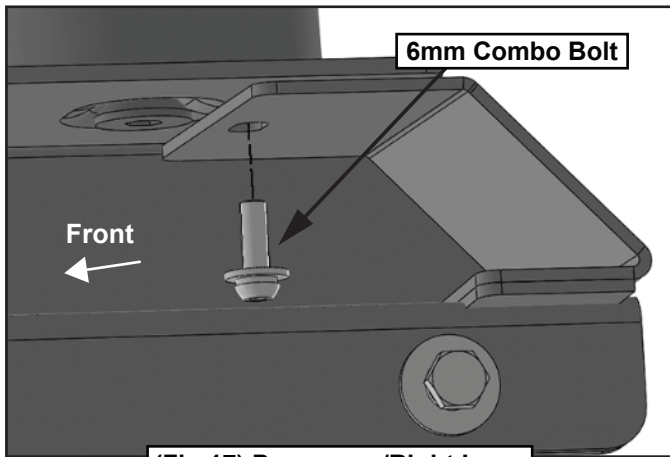

(Fig 17) Passenger/Right Logo Plate installation (Optional)

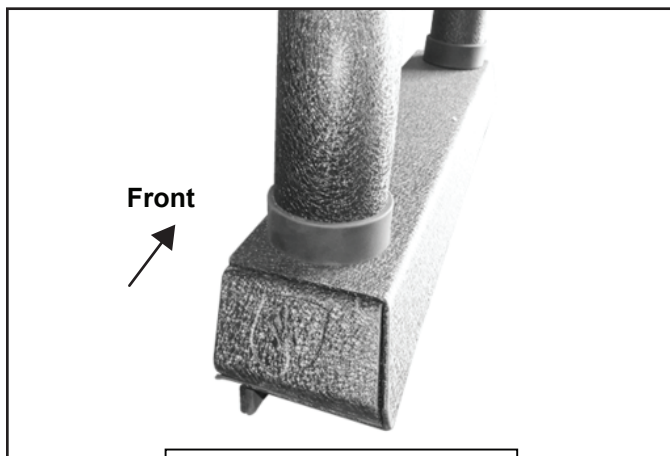

(Fig 18) Logo Plate installed

## STEP 12

Do periodic inspections to the installation to make sure that all hardware is secure and tight.